

THE INFORMATION CONTAINED HEREIN IS CONSIDERED
"PROPRIETARY" TO BEL FUSE INC. AND SHALL NOT BE
COPIED, REPRODUCED OR DISCLOSED WITHOUT THE
WRITTEN APPROVAL OF BEL FUSE INC.

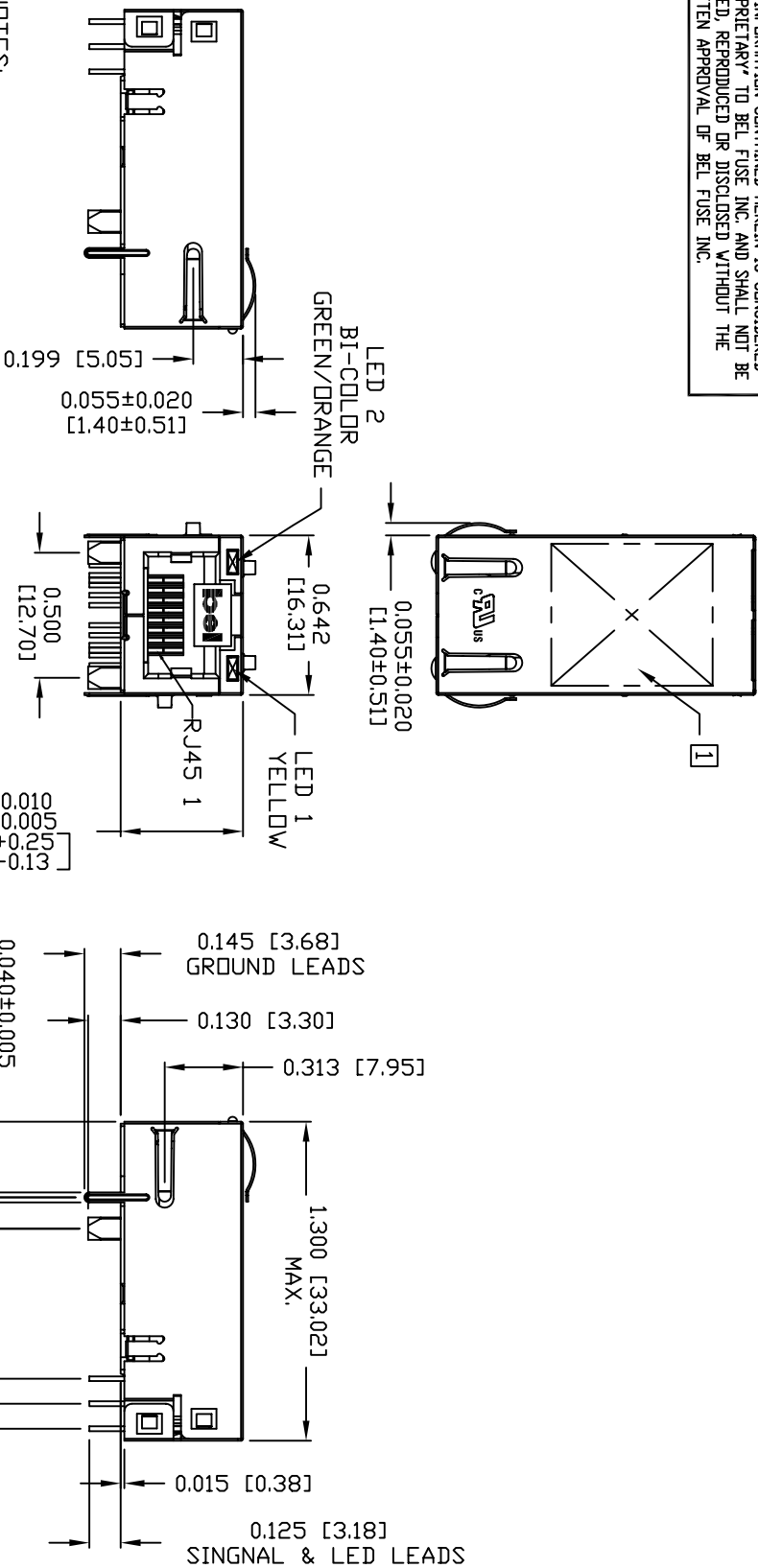

NOTES:

- PLASTIC HOUSING: THERMOPLASTIC PBT
- FLAMMABILITY RATING UL 94V-0
- CONTACTS PLATING: 50 MICRON-INCH HARD GOLD PLATING
- TIN-COATED COPPER WIRE, DIA 0.018 INCH.
- METAL SHIELD: NICKEL PLATED ON COPPER ALLOY
- CALL GROUND LEADS ARE SOLDER DIPPED)
- MARK PART WITH MFG. LOGO, MFG. NAME, PART NUMBER, DATE CODE.
- us UL RECOGNIZED - FILE #E196366 AND E169987.
- ROHS COMPLIANCE, PER EU DIRECTIVE 2002/95/EC

ORIGINATED BY	DATE	TITLE	PART NO. / DRAWING NO.	STANDARD DIM.	[] METRIC DIM. AS REFERENCE
QIN/BILL	11-25-05	gigabit MagJack® (8 cores, Tab Up) L826-1X1T-43-F	L8261X1T43-F	TOL. IN INCH	UNIT : INCH [mm]
DRAWN BY	DATE	FILE NAME		.X	SCALE : N/A
TING	11-25-05	L8261X1T43-F B.D.W.G		.XX	SIZE : A4
				.XXX	PAGE : 3



THE INFORMATION CONTAINED HEREIN IS CONSIDERED
 "PROPRIETARY" TO BEL FUSE INC. AND SHALL NOT BE
 COPIED, REPRODUCED OR DISCLOSED WITHOUT THE
 WRITTEN APPROVAL OF BEL FUSE INC.

RECOMMENDED PCB FOOTPRINT

<COMPONENT SIDE VIEW>

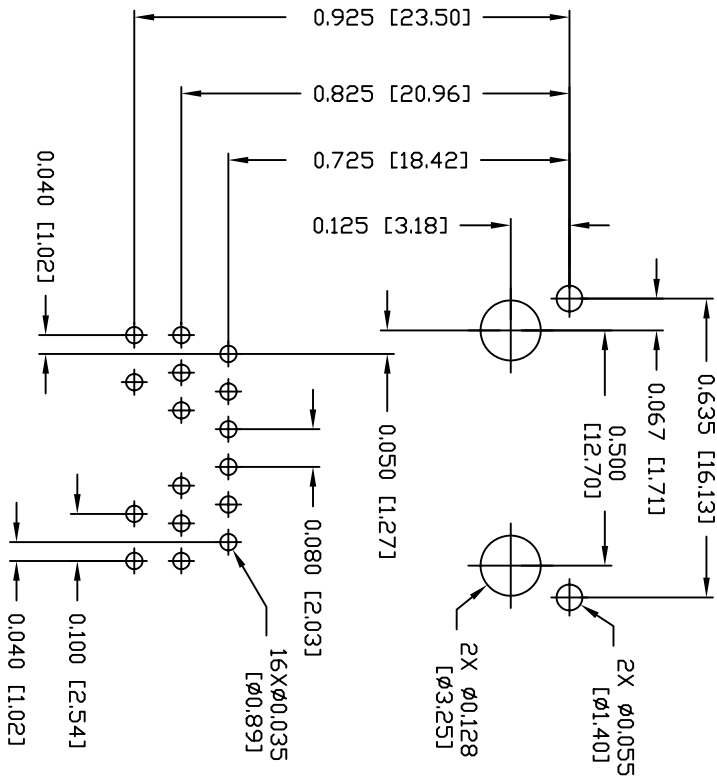

- 1 2 3 4 5 6
- 7 8 9
- 10 11 12
- 13 14
- 15 16

ORIGINATED BY	DATE	TITLE	PART NO. / DRAWING NO.	STANDARD DIM.	[] METRIC DIM. AS REFERENCE	REV. :	SIZE :
QIN/BILL	11-25-05	gigabit MagJack® (8 cores, Tab Up) L826-1X1T-43-F	L8261X1T43-F	TOL. IN INCH	UNIT : INCH [mm]	B	A4
DRAWN BY	DATE	FILE NAME	L8261X1T43-FB.DWG	.X	SCALE : N/A		
TING	11-25-05			.XXX	±0.004		PAGE : 4

DC0002(2)032305

This document is electronically generated. This is a controlled copy if used internally



THE INFORMATION CONTAINED HEREIN IS CONSIDERED "PROPRIETARY" TO BEL FUSE INC. AND SHALL NOT BE COPIED, REPRODUCED OR DISCLOSED WITHOUT THE WRITTEN APPROVAL OF BEL FUSE INC.

SUGGESTED PANEL OPENING

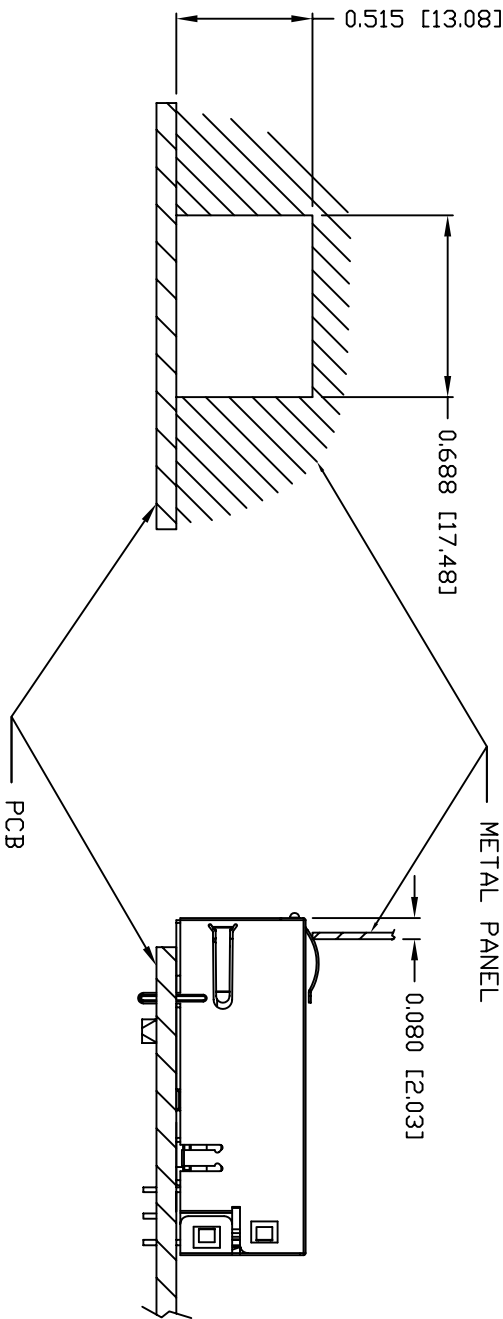

NOTE:

THE DISTANCE OF PANEL INSIDE SURFACE RELATIVE TO FRONT SURFACE OF PART IS ONLY A SUGGESTION. IN CASE THIS DISTANCE IS DIFFERENT, THE REQUIRED PANEL OPENING DIMENSIONS CHANGE ACCORDINGLY.

PACKING INFORMATION

PACKING TRAY: 0200-9999-D6 (TOP)

0200-9999-D7 (BOTTOM)

PACKING QUANTITY: 40 PCS FINISHED GOODS PER TRAY

11 TRAYS (440 PCS FINISHED GOODS) PER CARTON BOX

NOTE: CARDBOARDS ARE PLACED BETWEEN LAYERS OF PACKING TRAY INSIDE CARTON BOX
(INCLUDE THE UPPERMOST AND LOWERMOST TRAY)



ORIGINATED BY	DATE	TITLE		PART NO. / DRAWING NO.		STANDARD DIM.		[] METRIC DIM. AS REFERENCE	
QIN/BILL	11-25-05	gigabit MagJack® (8 cores, Tab Up) L826-1X1T-43-F		L8261X1T43-F		TOL. IN INCH		UNIT : INCH [mm]	
DRAWN BY	DATE			FILE NAME		.X		SCALE : N/A	
TING	11-25-05			L8261X1T43-F.B.DWG		.XX			
						.XXX		±0.004	
								PAGE : 5	

