

A

B

C

D

PART NUMBER	DIM "A"
10045368-101LF	1.32
10045368-102LF	2.60
10045368-103LF	4.20
10045368-104LF	5.70
10045368-105LF	7.30

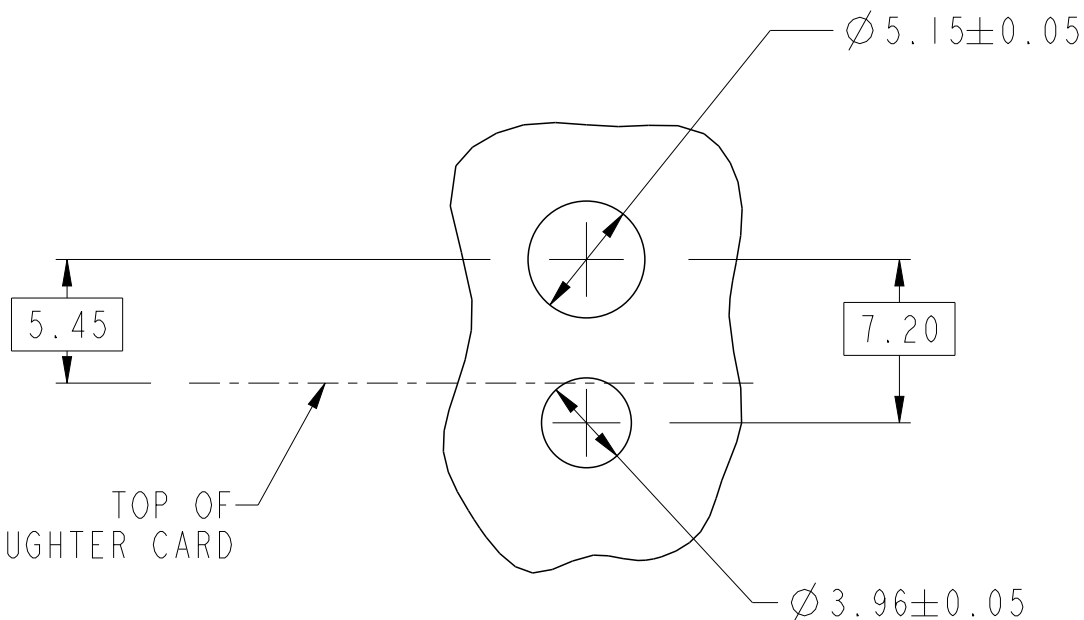
TOP OF
DAUGHTER CARD

NOTES:

1. MATERIAL: ZINC ALLOY.
2. FINISH: CHROMATE.
- ③ REFER TO CUSTOMER DRAWING 10035911 FOR INFORMATION REGARDING PCB LAYOUT OF POWER AND GUIDE MODULES RELATIVE TO SIGNAL MODULES.
- 4 THIS PRODUCT MEETS EUROPEAN UNION DIRECTIVES AND OTHER COUNTRY REGULATIONS AS DESCRIBED IN GS-22-008.
- 5 PACKAGING MEETS GS-14-920 LEAD FREE LABELING SPECIFICATION.

SEE NOTE 3
SCALE 3:1

spec ref -				dr	Chen-Hong Tan	2005/08/18	projection 	MM 	size	A4	scale	3:1
tolerance std - ASME Y14.5 TOLERANCES UNLESS OTHERWISE SPECIFIED				eng	Terry Luo	2019/04/24			ecn no ELX-DG-33324-1			
				chr	-	-						
				appr	Heaven Cen	2019/04/25	product family -			rel level Released		
surface - ASME Y14.5 	linear	0.X	±0.3	Amphenol FCi			title 7.2mm VERTICAL GUIDE PIN 2/3 PR, 25.25mm Long			dwg no 10045368		rev B
		0.XX	±0.10									
		0.XXX	±0.05									
angular	0°	±2°				cat. no. -			Product - Customer Drw		sheet 2 of 2	

Creo File - REV E - 2016-02-12

2

3

PDS: Rev :B

STATUS:Released

Printed: Apr 25, 2019