

EVC 135 Contactor (Continued)

Dimensions

EVC 135 Contactor Bottom Mount

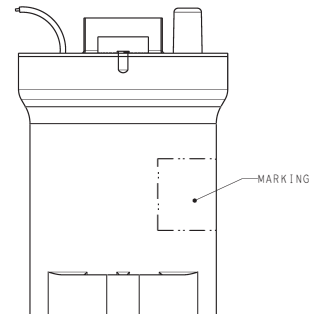
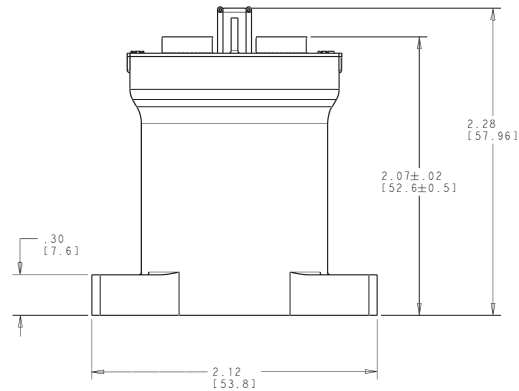
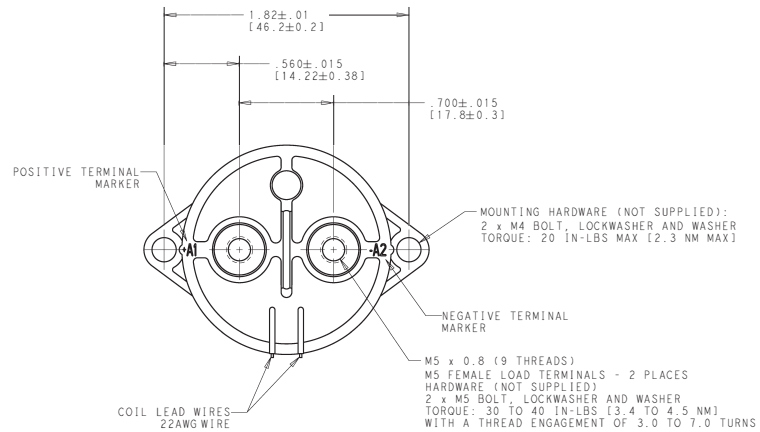

Dimensions

EVC 135 Contactor Side Mount

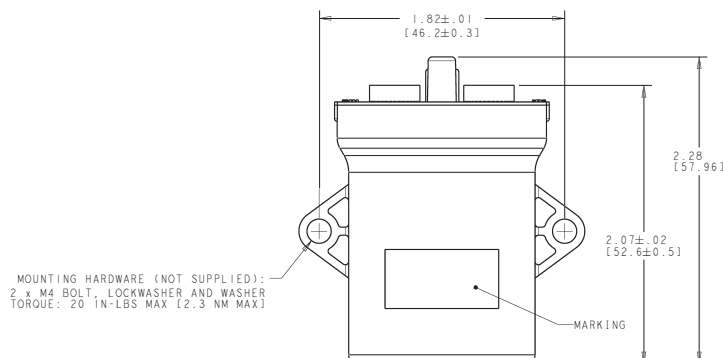
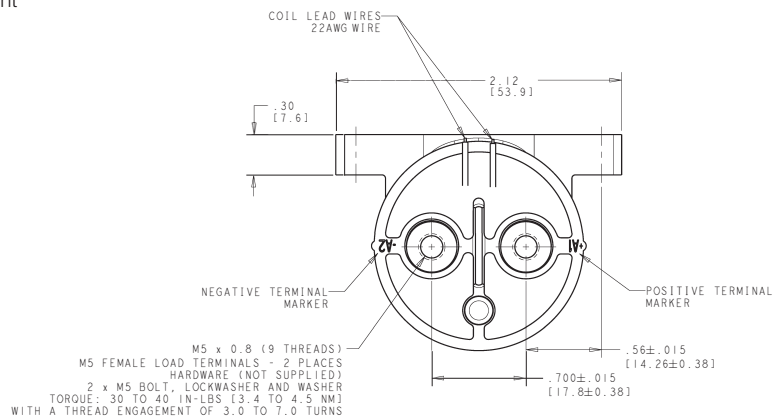

EVC 135 Contactor (Continued)

Contact performance

Life cycle vs. resistive load at 400VDC

(Chart is for engineering guideline, verification at 2,200VRMS for dielectric withstand)

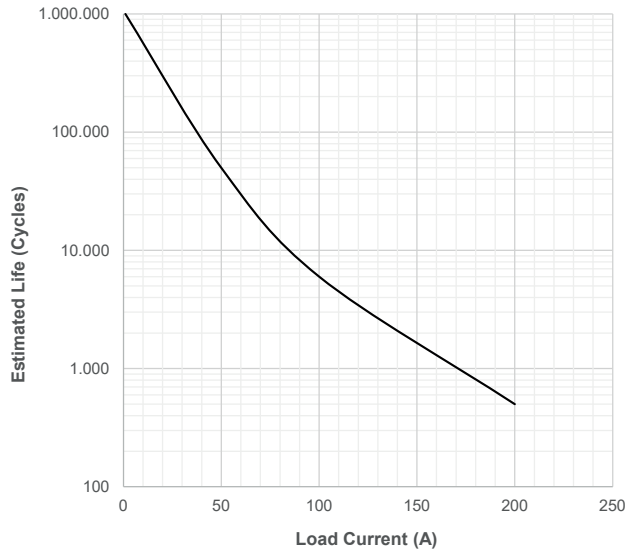

Notes:

- 1) The maximum make current is 600A to avoid contact welding.
- 2) For reverse current, the performance will roughly be reduced by 50% of the cycle life in forward direction.

Contacts closed into capacitor precharge sequence at various time constants

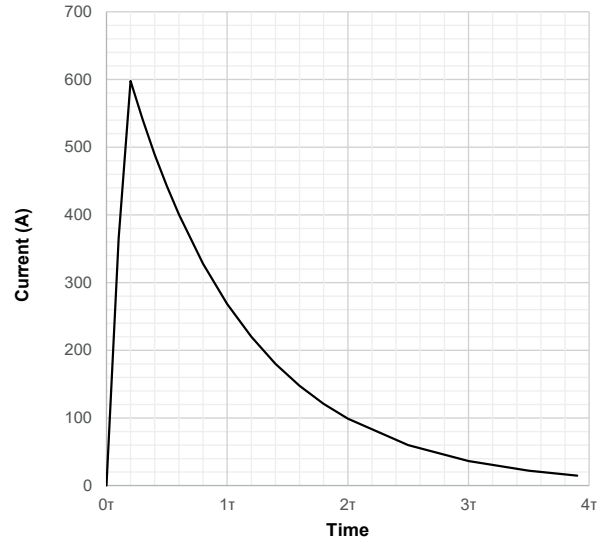

Notes:

- 1) Because higher current causes more damage to contact surface, at least 95% precharge is recommended.
- 2) Inrush current dependent upon RC time constant and precharge timing sequence.

Estimated fuse guide for EVC 135 contactors

(Reference only – not to be used for actual fuse sizing)

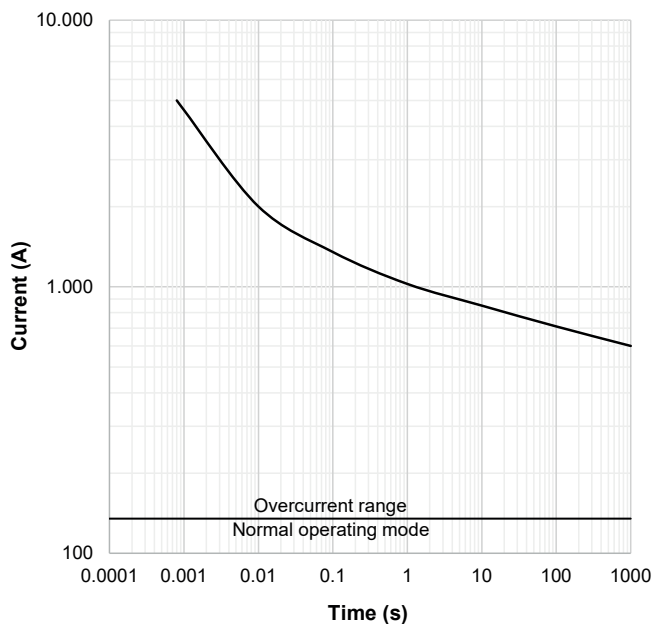

EVC 135 Contactor (Continued)

| Product code structure | | Typical product code | | | | | |
|----------------------------|---|---|-----------|----------|----------|----------|----------|
| | | EVC 135 | -4 | B | N | G | A |
| Type | EVC 135 EVC 135 Contactor | | | | | | |
| Coil | 4 12VDC (15.3Ω coil) | 6 12VDC (3.8Ω coil) | | | | | |
| | 5 12VDC (26.0Ω coil) | 7 24VDC (96.0Ω coil) | | | | | |
| Coil wire length | A 15 inches (380mm) | B 6 inches (150mm) | | | | | |
| | | | | | | | |
| Coil termination | N None – stripped wires | C Customer specific connector | | | | | |
| | | | | | | | |
| Mounting & power terminals | G Bottom mount (2 x #8), M5 x 10 | H Side mount (2 x #8), M5 x 10 | | | | | |
| | | | | | | | |
| Arc magnet | A Grade 8 (Standard) | B Grade 30 (required for UL approval at >450VDC) | | | | | |
| | | | | | | | |

Production in Americas (only)

| Product code | Coil resistance | Coil voltage | Economization or voltage reduction | Coil leads | Mounting | Part number |
|---------------|-----------------|--------------|------------------------------------|------------|----------|-------------|
| EVC 135-4BNGA | 15.3Ω | 12VDC | Required | 6 inches | Bottom | 2203194-1 |
| EVC 135-5ANGA | 26.0Ω | | Optional | 15 inches | | 2138622-1 |
| EVC 135-7BNGA | 96.0Ω | 24VDC | | 6 inches | | 2138602-1 |
| EVC 135-4ANHA | 15.3Ω | 12VDC | Required | 15 inches | Side | 2272229-1 |
| EVC 135-4BNHA | | | | 6 inches | | 2138168-1 |
| EVC 135-5BNGA | 26.0Ω | | Optional | | Bottom | 2098371-1 |
| EVC 135-6BNGA | 3.8Ω | | Required | | | 2138084-1 |

Production in Asia (only)

| Product code | Coil resistance | Coil voltage | Economization or voltage reduction | Coil leads | Mounting | Part number |
|---------------|-----------------|--------------|------------------------------------|------------|----------|-------------|
| EVC 135-4BNGA | 15.3Ω | 12VDC | Required | 6 inches | Bottom | 2219560-2 |
| EVC 135-5ANGA | 26.0Ω | | Optional | 15 inches | | 2219560-7 |
| EVC 135-5BNGA | 26.0Ω | | Optional | | Bottom | 2219560-3 |
| EVC 135-6BNGA | 3.8Ω | | Required | | | 2219560-1 |