

250 Series Printed Circuit Board Tabs

Stock Thickness — .032 [0.81]

Board Hole Size —
.055 ± .002 [1.40 ± 0.05] Dia.



W Piece ¹	Dimensions			Material and Finish	UL	SP ^d	Terminal Part No.	
	L	K	E				Strip ²	Loos
.312 7.92	.502 12.75	.125 3.18	.312 7.92	Tin Plated Brass	X	X	63839-1 ³	—
	.547 13.89	.157 3.99	.312 7.92	Tin Plated Brass	X	X	63986-1	—
	.552 14.02	.150 3.81	.312 7.92	Tin Plated Brass	—	—	1217566-1	—
.295 7.49	.622 15.80	.125 3.18	.312 7.92	Tin Plated Brass	X	X	—	62409-1 ³
					—	—	—	1217056-1
.280 7.11	.487 12.37	.125 3.18	.312 7.92	Tin Plated Brass	X	X	62650-1 ³	—
	.532 13.51	.175 4.45	.312 7.92	Tin Plated Brass	X	X	63650-1 ³	—
	.622 15.80	.125 3.18	.452 11.48	Tin Plated Brass	X	X	—	63900-1
					—	—	63755-1 ³	—

¹ Board Hole Size: .060/.053 [1.52/1.35] Dia.

² Insertion equipment available.

Stock Thickness — .032 [0.81]

Board Hole Size —
.100 ± .002 [2.54 ± 0.05] Dia.

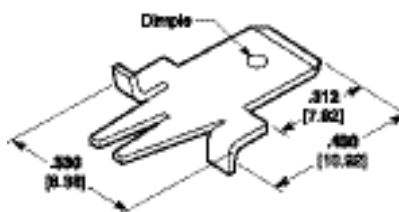

Material and Finish	UL	SP ^d	Terminal Part No.	
			Strip ¹	Loose Piece
Tin Plated Brass	X	X	63066-1	63067-1

¹ Insertion equipment available.

250 Series Printed Circuit Board Tabs (Continued)

Stock Thickness — .032 [0.81]

Board Hole Size —
.055 ± .002 [1.40 ± 0.05] Dia.

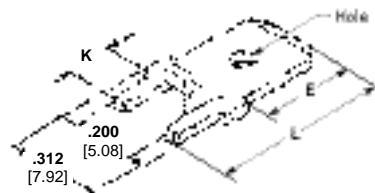

Dimensions			Material and Finish	UL	SP	Terminal Part No.	
L	K	E				Strip ¹	Loose Piece
.552 14.02	.150 3.81	.312 7.92	Tin Plated Brass	X	X	63862-1 ²	—
.582 14.78	.180 4.57	.312 7.92	Tin Plated Brass	X	X	63824-1	63849-1
.582 14.78	.180 4.57	.312 7.92	Tin Plated Brass	—	—	—	1217421-1
.650 16.51	.150 3.81	.410 10.41	Tin Plated Brass	X	X	1217126-1 ²	—
.710 18.03	.150 3.81	.470 11.94	Tin Plated Brass	—	—	1217125-1	1217169-1
.780 26.18	.150 3.81	.540 13.72	Tin Plated Brass	—	—	1217127-1	—
.780 26.18	.150 3.81	.540 13.72	Tin Plated Brass	X	X	—	1217167-1

¹ Insertion equipment available.

² Dimple.

Stock Thickness — .032 [0.81]

Board Hole Size —
.055 ± .002 [1.40 ± 0.05] Dia.

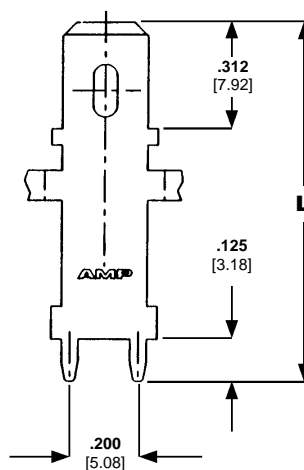

Dimension L	Material and Finish	UL	SP	Terminal Part No.
1.062 26.97	Tin Plated Brass	X	X	63949-1
1.207 30.66	Tin Plated Brass	X	X	63950-1

250 Series Printed Circuit Board Tabs (Continued)

Right Angle Printed Circuit Board Tab

Stock Thickness — .032 [0.81]

Board Hole Size —
.055 ± .002 [1.40 ± 0.05] Dia.

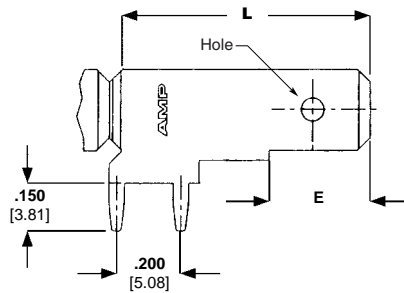

Dimensions		Material and Finish	UL	SP	Terminal Part No.	
E	L				Strip ¹	Loose Piece
.312 7.92	.800 20.32	Tin Plated Brass	X	X	63951-1	1217754-1
.358 9.09	.630 16.00	Tin Plated Brass	—	—	928814-1	—
.738 18.74	1.00 25.40	Tin Plated Brass	—	—	63952-1	—

¹ Insertion equipment available.

205 Series Printed Circuit Board Only

Stock Thickness — .020 [0.51]

Board Hole Size —
.100 — .095 [2.54 — 2.41] Dia.

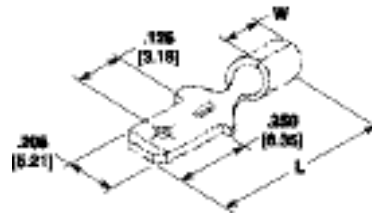

Dimensions		Material and Finish	UL	SP	Terminal Part No.	
L	W				Strip ¹	Loose Piece
.525 13.34	.070 1.78	Tin Plated Brass	X	X	62411-1 ¹	—
.545 13.84	.160 4.06	Tin Plated Brass	X	X	60284-2 ¹	—

¹ Loose piece only.

.250/.205 Printed Circuit Board Receptacle

Stock Thickness — .016 [0.41]

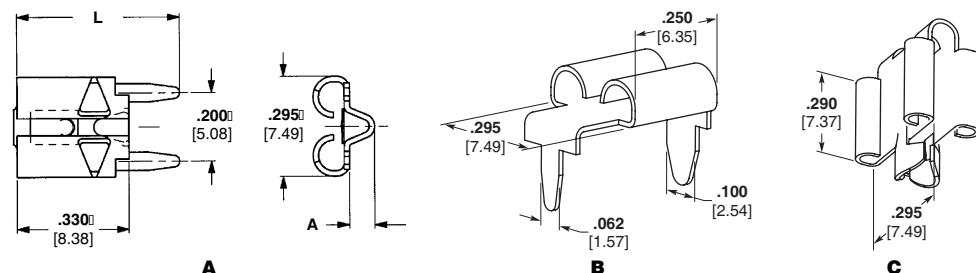

Style	Fits Tab	Dimensions		Material and Finish	UL	SP	Part No.	
		A	L				Strip	Loose Piece
A	.032 0.81 (LIF)	.075 1.91	.480 12.19	Tin Plated Brass	—	—	63968-1	—
	.032 0.81	.075 1.91	.480 12.19	Tin Plated Brass	—	—	63969-1	1217080-1
	.025 0.64 (LIF)	.075 1.91	.480 12.19	Tin Plated Brass	—	—	63994-1	—
	.025 0.64	.075 1.91	.510 12.95	Tin Plated Brass	—	—	1217137-1 ²	—
	.025 0.64	.075 1.91	.480 12.19	Tin Plated Brass	—	—	1217180-1	—
B	.020 0.51	—	—	Tin Plated Phos Bronze	—	—	1217107-1 ¹	—
C	.250 x .016 6.35 x 0.41 Spade	—	—	Tin Plated Brass	—	—	62751-1	62806-1

¹ Horizontal mount.

² .180 [4.57] length — solder legs.

**187 Series
Printed Circuit Board Tabs**

Stock Thickness — .020 [0.51]

FASTON Printed Circuit Board Tabs and Receptacles (Continued)

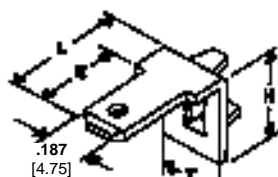

A



B

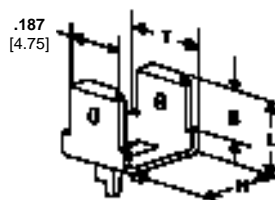

C

Type	Board Thickness	Dimensions				Material and Finish	UL	SP	Terminal Part No.
		T	L	E	H				
A	.055	.250	.332	.250	.283	Pre-Tin Brass	X	X	61543-1 ²
	1.38	6.35	8.43	6.35	7.19				
B	.062	.250	.332	.250	.283	Pre-Tin Brass	X	X	62403-1 ²
	1.57	6.35	8.43	6.35	7.19				
C	.062	—	.545	.250	—	Tin-Plated Brass	X	X	61907-1 ¹
	1.57	—	13.84	6.35	—				
C	.062	.250	.332	.250	.303	Pre-Tin Brass	X	X	62221-1 ²
	1.57	6.35	8.43	6.35	7.70				

¹ Loose piece only.

² Insertion equipment available.

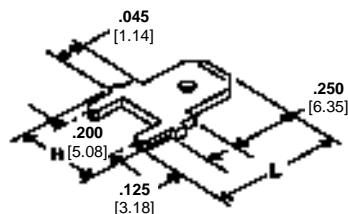

Tab Part No.	Board Thickness	Hole Size	Dimensions		Material and Finish	UL	SP	Terminal	
			L	H				Strip ²	Loose Piece
.032	.053-.057	.487	.280	.285	Tin Plated Brass	X	X	63525-1 ¹	1217057-1 ¹
0.81	1.35-1.45	12.37	7.11	7.24					
.020	.050-.054	.487	.285	.312	Tin Plated Brass	X	X	63603-1	1217131-1
0.51	1.27-1.37	12.37	7.24	7.92					
		.440	.312		Tin Plated Brass	X	X	63838-1	—
		11.18	7.92						

¹ Dimple.

² Insertion equipment available.

**187 Series
Printed Circuit Board Tabs**
(Continued)

FASTON Printed Circuit Board Tabs and Receptacles (Continued)

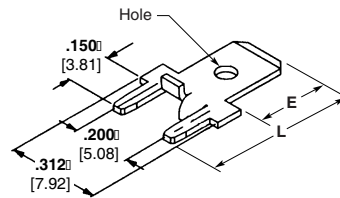

Tab Thickness	Dimensions		Material and Finish	UL	SF	Terminal Part No.	
	L	E				Strip ³	Loose Piece
.032 0.81	.490 12.45	.250 6.35	Tin Plated Brass	X	X	63860-1 ¹	—
	.710 18.03	.470 11.94	Tin Plated Brass	X	X	1217133-1	—
	.635 16.13	.395 10.03	Tin Plated Brass	—	—	—	1217332-1 ²
.020 0.51	.490 12.45	.250 6.35	Tin Plated Brass	X	X	63823-1	63982-1

¹ Dimple.

² No hole or dimple.

³ Insertion equipment available.

**Right Angle Printed Circuit
Board Tab**

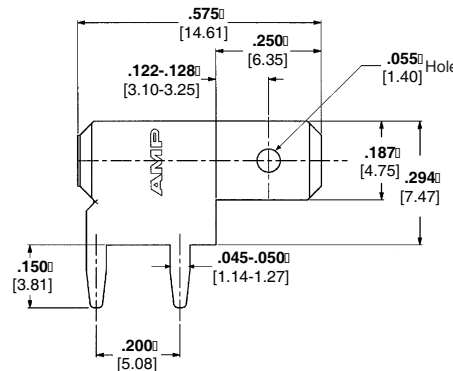

Stock Thickness	Board Hole Size	Material and Finish	UL	SF	Terminal Part No.
.032 0.81	.053-.057 1.35-1.45	Tin Plated Brass	X	X	1217061-1
			—	—	1217756-1 ¹
.020 0.51	.050-.054 1.27-1.37	Tin Plated Brass	X	X	1217062-1
			—	—	1217156-1 ¹

¹ Loose piece.

**Tab Caps 187 and 250
Series**

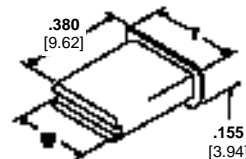

Tab Size	Material	UL 94 ¹	Color	Dimensions		Insulator Part No.
				T	W	
"187" Series .020 [0.51] Thick	Nylon	V2	Natural	.320 8.13	.260 6.60	360041-1
"250" Series .032 [0.81] Thick	Nylon	V2	Natural	.380 9.65	.320 8.13	360042-1

¹ Flammability rating.

.110 Series Printed Circuit Board

Stock Thickness — .020 [0.51]

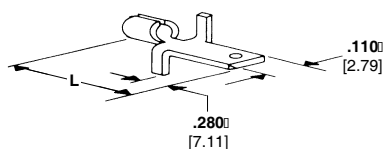

A

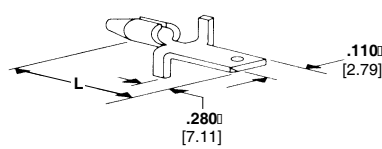

B

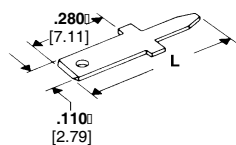

C

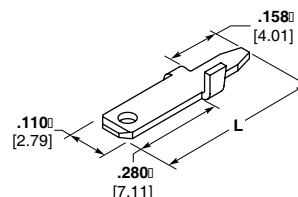

D

Style	Mating Hole Diameter	Dim. L	Material and Finish	AL	SP [®]	Terminal Part No.
A	.060-.055 1.52-1.40	.490 12.45	Tin Brass	X	X	61134-3 ¹
B	.067-.063 1.70-1.60	.485 12.32	Tin Brass	X	X	61968-1 ² 62437-1 ¹
C	.044-.048 1.12-1.22	.490 12.45	Tin Brass	X	X	62395-1 ²
		.622 15.80	Tin Brass	X	X	63756-1 ^{2,3}
		.910 23.11	Tin Brass	—	—	63794-1 ⁴
		.550 13.97	Tin/Lead	—	—	1217121-1 ¹
		.622 15.80	Tin Brass	—	—	1217514-1
D	.067-.073 1.70-1.85	.490 12.45	Pre-tin/ Pre-copper	X	X	62669-1 ²
	.062-.068 1.57-1.73	.545 13.84	Tin Brass	—	—	1217577-1 ²

¹ Loose piece only.

² Insertion machine available.

³ .032 [0.81] Stock.

⁴ .060 [1.52] Tab width.

Right Angle Printed Circuit Board Tabs

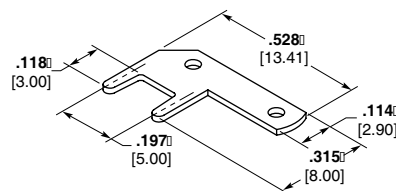

Tab Thickness	PCB Hole Dia. +0/-.01 [+0/-.03]	Material and Finish	AL	SP [®]	Terminal Part No.
.032 0.81	.055 1.40	Tin Plated Brass	—	—	725963-2
.020 0.51	.051 1.30	Tin Plated Brass	—	—	725996-2

250 Series

FASTON Tab Adapters

Fits Tab — .032 [0.81]

FASTON Printed Circuit Board Tabs and Receptacles (Continued)



A



B

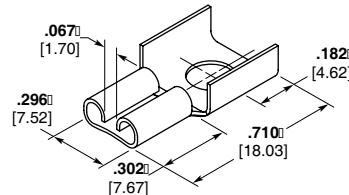

C

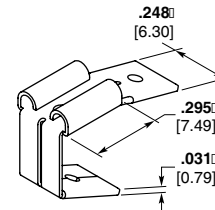

D

Style	Stock Thickness	Dimensions			Material and Finish	A	SP	Terminal Part No.
		W	L	E				
A	.018 0.46 Recpt.	.650 16.51	.770 19.56	.305 7.75	Brass	X	X	61765-1
	.032 0.81 Tabs				Tin Plated Brass	X	X	61765-2 ¹ 1217033-1
B	.018 0.46	.300 7.62	.700 11.78	—	Tin Plated Brass	X	X	61810-2
						X	X	63918-1 ²
C	.016 0.41	—	—	—	Nickel Plated Steel	—	—	151302-2
	.016 0.41				Brass (90°)	—	—	152422-1
D	.016 Recpt. 0.41	—	—	—	Brass	—	—	726308-1
	.032 Tabs 0.81							

¹ No tab stop on receptacle.

² Fits .025 [0.64] thick tab.

187 Series

FASTON Tab Adapters

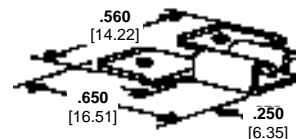

A

Style	Stock Thickness	Receptacle Fits Tab	Material and Finish	A	SP	Terminal Part No.
A	.013 0.33 Recpt.	.020 0.51	Tin Plated Brass	X	X	61045-2
	.020 0.51 Tabs					
	.013 0.33 Recpt.	.032 0.81	Tin Plated Brass	X	X	63699-1
	.032 0.81 Tabs					

FASTON Printed Circuit Board Tabs and Receptacles (Continued)

Tab Receptacles



A



B



C



D



E



F

Wire Range		Type	Insul. Dia. Range	Stock Thk.	Material and Finish	Fits Tab	Dimensions			Part No.
AWG	mm ²						E	L	W	
26-22	0.12-0.4	B	.035-.065 0.89-1.65	.010 .025	Pre-Tin Brass	.031 x .093 0.79 x 2.36	.190 4.83	.475 12.06	.120 3.05	61813-1 ⁵
		A	.040-.080 1.02-2.03	.010 0.25	Brass	.045 x .045 1.14 x 1.14	.130 3.3	.372 9.45	.095 2.41	60524-1
					Tin Plated Beryllium Copper	.045 x .045 1.14 x 1.14	.130 3.3	.372 9.45	.095 2.41	60524-5
					Tin Plated Brass	.031 x .062 0.79 x 1.57	.187 4.75	.462 11.73	.090 2.29	60900-1 ¹
					Gold Plated Brass	.031 x .062 0.79 x 1.57	.187 4.75	.462 11.73	.090 2.29	60900-2
24-20	0.2-0.6	B	.040-.080 1.02-2.03	.010 0.25	Tin Plated Brass	.031 x .062 0.79 x 1.57	.187 4.75	.462 11.73	.090 2.29	60900-4 ²
					Gold Plated Brass	.031 x .062 0.79 x 1.57	.187 4.75	.462 11.73	.090 2.29	60900-5 ⁷
					Tin Plated Brass	.031-.062 0.79-1.57	.187 4.75	.462 11.73	.090 2.29	63887-1
		F	—	.010 0.25	Tin Plated Brass	.015 x .050 0.38 x 1.27	.145 3.68	.310 7.87	.070 1.78	62352-1
22-20	0.3-0.6	E	—	.010 0.25	Tin Plated Brass	.037 x .125 0.94 x 3.18	.190 4.83	.425 10.8	.160 4.06	41989
		A	.060-.110 1.52-2.79	.010 0.25	Tin Plated Brass	.031 x .062 0.79 x 1.57	.130 3.3	.372 9.45	.090 2.29	61489-1
					Gold Plated Brass	.031 x .062 0.79 x 1.57	.130 3.3	.372 9.45	.090 2.29	61616-1
22-18	0.3-0.9	B	.050-.085 1.27-2.16	.010 0.25	Pre-Tin Brass	.010 x .093 0.25 x 2.36	.190 4.83	.480 12.19	.120 3.05	63391-1 ^{3,4}
					Pre-Tin Brass	.010 x .093 0.25 x 2.36	.190 4.83	.480 12.19	.120 3.05	63391-2 ⁴
					Pre-Tin Brass	.032 x .103 0.81 x 2.62	.200 5.08	.480 12.19	.126 3.2	60252-1 ⁶
		B	.080-.120 2.03-3.05	.010 0.25	Pre-Tin Brass	.020 x .103 0.51 x 2.62	.200 5.08	.480 12.19	.126 3.2	60432-1 ⁶
					Tin Plated Brass	.020 x .156 0.51 x 3.96	.200 5.08	.480 12.19	.179 4.55	62399-1
20-18	0.5-0.9	D	—	.010 0.25	Brass	.010 x .110 0.25 x 2.79	.200 5.08	.380 9.65	.148 3.76	62589-1
18-14	0.8-2.0	C	—	.025 0.64	Brass	.060 x .250 1.52 x 6.35	.520 13.2	.985 25.02	.250 6.35	60312-1

¹ Available in loose piece form, order Part No. 61454-1.

² Reverse reel of 60900-1.

³ Loose piece form, of Part No. 63391-2.

⁴ Compliant base.

⁵ No dimple.

⁶ Dimple.

⁷ Reverse reel of 60900-2.

FASTON RAST 5 Tab Header Assembly, 250 Series

Product Facts

- .250 x .032 [6.3 x 0.8]
FASTON Tabs built on 5 mm centerlines
- Shrouded Header Assembly that conforms to the European RAST 5 Standard
- Mating Tyco Electronics Connector Families include AMP Positive Lock RAST 5 Connector System, AMP Standard Timer RAST 5, AMP multifitting, AMP multifitting MKII, AMP MONO-SHAPE TAB MKI, and AMP MONO-SHAPE MKII
- Vertical and Right-Angle Versions available in 2 through 8 positions
- Tin Plated Brass Tabs are Standard, Silver Plated Tab Versions are available upon Request
- Lead Free Design is RoHS and ELV Compliant
- UL 94 V-0 Housing meets Glow Wire IEC 60695-1 Section 30.2.3 – 750° NO FLAME
- Agency approvals will include UL, CSA, TUV, and VDE

Material

UL 94 V-0, 6/6 Nylon

FASTON Printed Circuit Board Tabs and Receptacles (Continued)

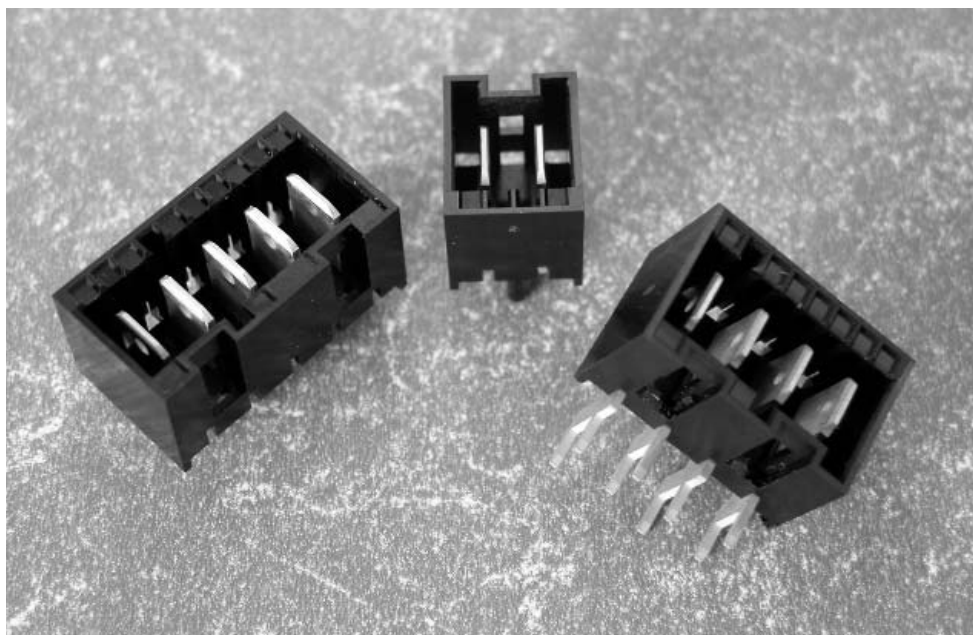

The AMP FASTON RAST 5 Tab Header Assembly system is designed to provide a RAST 5 interface to a Printed Circuit Board. The RAST 5 Standard defines and standardizes the connector mating interface. 250 Series Tabs are placed on 5mm center lines with a plastic shroud that has keying, polarization, and locking features that help prevent mismatching of the corresponding RAST 5 Female Receptacle Housing. The Header Assembly is

designed to accept any RAST 5 compliant Female receptacle system or individual Quick Connects.

The most common application for this product is for Household Appliance Controls where OEM's want to minimize the possibility of crossed wires. It is also suited for other applications such as Gaming, Vending, and Exercise Equipment controls as well as Residential, Commercial and Industrial HVAC and light industrial equipment.

The system comes fully assembled and is easily press fit into the board for the soldering operation. Preassembly of the tabs into the Header ensures tab perpendicularity to the board. The solder leg PCB layout is based on the Industry Standard for similar systems available on the market. To further ensure correct placement onto the board, the vertical system includes a plastic post which allows Header placement to be polarized.

See Tyco Electronics Catalogs
296599, 889803, 1308197,
1308209 for the complete line of
RAST products.

FASTON RAST 5 Tab Header Assembly, 250 Series

(Continued)

FASTON Printed Circuit Board Tabs and Receptacles (Continued)

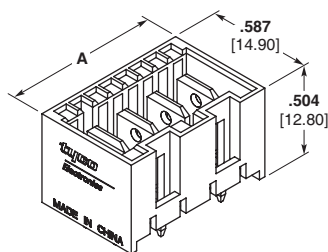

Vertical Orientation

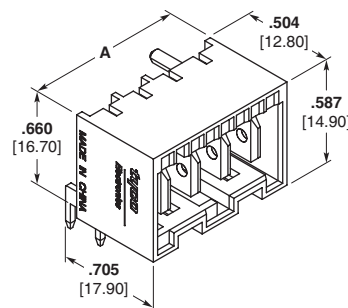

Right Angle Orientation

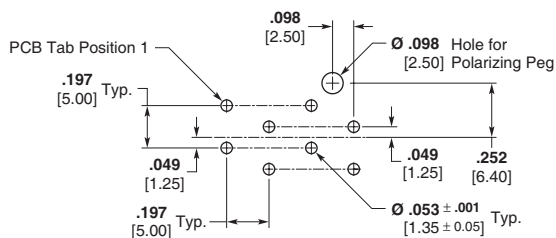

**Vertical Orientation PCB Layout
(Ref.) from Component Side**

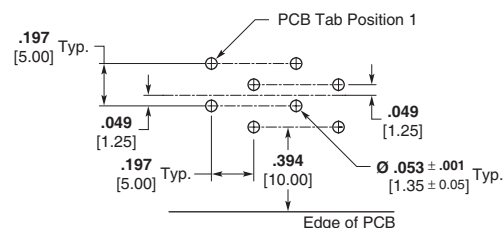

**Right Angle Orientation PCB Layout
(Ref.) from Component Side**

No. of Positions	RAST 5 Configuration	Dim. A	Part Numbers	
			Vertical	Right Angle
2	02-A	.484 [12.30]	521382-2	521384-2
	02-B	.484 [12.30]	1-521382-2	1-521384-2
	02-C	.484 [12.30]	2-521382-2	2-521384-2
	02-E	.484 [12.30]	3-521382-2	3-521384-2
	02-G	.484 [12.30]	4-521382-2	4-521384-2
	02-I	.484 [12.30]	5-521382-2	5-521384-2
	02-P	.484 [12.30]	6-521382-2	6-521384-2
3	03-A	.681 [17.30]	521382-3	521384-3
	03-B	.681 [17.30]	1-521382-3	1-521384-3
	03-D	.681 [17.30]	2-521382-3	2-521384-3
	—	.681 [17.30]	3-521382-3	3-521384-3
4	04-A	.878 [22.30]	521382-4	521384-4
	04-B	.878 [22.30]	1-521382-4	1-521384-4
	04-C	.878 [22.30]	2-521382-4	2-521384-4
	04-F	.878 [22.30]	3-521382-4	3-521384-4
	04-G	.878 [22.30]	4-521382-4	4-521384-4
	—	.878 [22.30]	5-521382-4	5-521384-4
5	05-B	1.075 [27.30]	521382-5	521384-5
	—	1.075 [27.30]	1-521382-5	1-521384-5
	—	1.075 [27.30]	2-521382-5	2-521384-5
	—	1.075 [27.30]	3-521382-5	3-521384-5
6	06-A	1.272 [32.30]	521382-6	521384-6
	06-D	1.272 [32.30]	1-521382-6	1-521384-6
7	07-C	1.469 [37.30]	521382-7	521384-7
	—	1.469 [37.30]	1-521382-7	1-521384-7
	—	1.469 [37.30]	2-521382-7	2-521384-7
	—	1.469 [37.30]	3-521382-7	3-521384-7
8	08-D	1.665 [42.30]	521382-8	521384-8
	—	1.665 [42.30]	1-521382-8	1-521384-8
	08-C	1.665 [42.30]	2-521382-8	2-521384-8

Refer to the Tyco Electronics Customer Drawing for additional details.

For more information related to the RAST 5 Standard, see Tyco Electronics Literature Distribution no. 1308243.