

SCALE 2:1

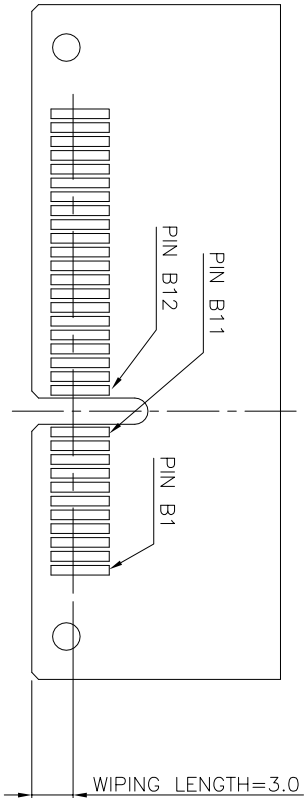

WIPING LENGTH=3.0

RECOMMEND OF PCB DIMENSIONS

# POS REF.	N	DIM "H"	DIM "E"
36	6	12.30	6.00
64	20	26.30	20.00
98	37	43.30	37.00
164	70	76.30	70.00

mat'l. code				surface		tolerance		projection		product family	
itr	ecm	no	dr	date	tolerances unless otherwise specified	ASME Y14.5				PCI_EXPRESS	
					angles	±0.20					
					±2°	.000±0.05					
					dr	ZHENHUA_LIU	2016-03-25				
					engr	ZHENHUA_LIU	2016-03-25				
					chr	STONE_LI	2016-03-25				
					dppd	PM_ZHENG	2016-03-25				
sheet	revision	L									
index	sheet	7									

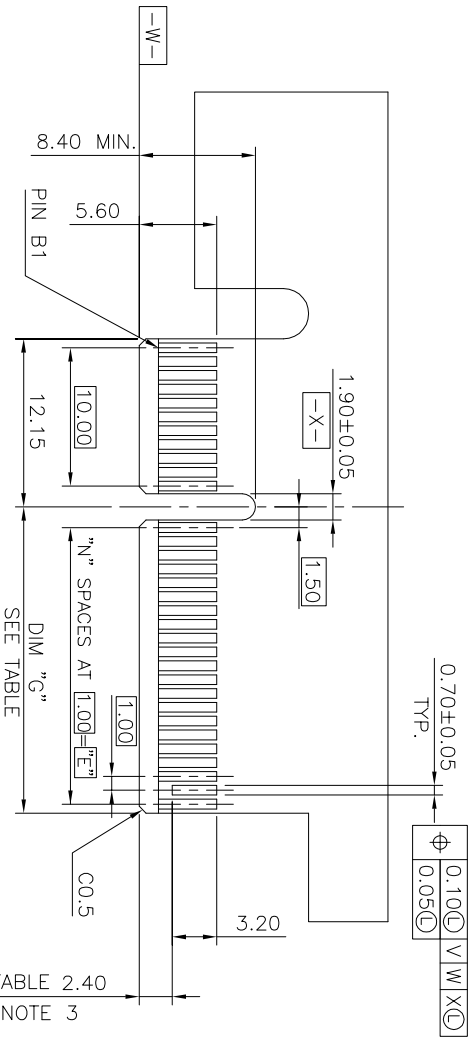

I/O PANEL DIRECTION
PRIMARY (COMPONENT) SIDE

I/O PANEL DIRECTION
SECONDARY (SOLDER) SIDE

# POS REF.	N	DIM "G"	"F"
36	6	8.15	B17
64	20	22.15	B31
98	37	39.15	B48
164	70	72.15	B81

ADD-IN CARD EDGE-FINGER DIMENSIONS

mat'l. code				surface		tolerance	projection	product family	
-				-		ASME Y14.5		PCI EXPRESS	
lfr	ecm no	dr	date	tolerances unless otherwise specified				title	
				angles	±2°	0.20	MM	PCI EXPRESS_CARD_EDGE_GEN3	
						0.00±0.05	scale N/A	STRADDLE_MOUNT_ASSY	
				dr	ZHENHUA_LIU	2016-03-25		dwg no	
				engr	ZHENHUA_LIU	2016-03-25		sheet 3 of 7	
				chr	STONE_LI	2016-03-25		10025026	
				dppd	PM_ZHENG	2016-03-25		size	
sheet	revision	L						A4	
index	sheet	7						CUSTOMER Drawing	

NOTES:

1. MATERIAL: RATED.
HOUSING: HIGH TEMPERATURE NYLON, GLASS FILLED UL94V-0
TERMINAL: COPPER ALLOY
PLATING: SEE PRODUCT NUMBER CODE
METAL BOARD LOCKS: COPPER ALLOY
FINISH: 100u" TIN OVER 50u" NICKEL UNDERPLATE
2. PRODUCT SPECIFICATION: GS-12-233
3. NO TIE BAR PERMITTED FROM CARD EDGE TO LEADING EDGE OF PAD FOR PINS A1 AND PIN NUMBERS "F".
4. CHAMFER EDGES MUST BE FREE OF CUTTING BURRS.
5. FREQUENCY & LOCATION AT SUPPLIER DISCRETION. RIDGE MAY BE CONTINUOUS WITH NO BREAKS.
6. ROHS COMPATIBLE PRODUCT SPECIFICATIONS
a - PLATING:
- "LF" MEANS THE PRODUCT IS LEAD-FREE
b - MANUFACTURING PROCESS COMPATIBILITY
- THE HOUSING WILL WITHSTAND EXPOSURE TO 260°C±5°C SOLDER BATH TEMPERATURE FOR 5 SECONDS IN A REFLOW SOLDER APPLICATION.

PRODUCT NUMBER CODE

10025026 -X 0 X 0 X 1 0 0

- HOUSING COLOR OPTIONS
- 0-NATURAL, HALOGEN
 - 1-BLACK, HALOGEN
 - 2-NATURAL, HALOGEN FREE
 - 3-BLACK, HALOGEN FREE

RESERVE

TERMINAL PLATING OPTIONS

- 0-50u" NI UNDERPLATE
- 30u" Au CONTACT AREA
- 100u" TIN TAIL AREA ----- COMPATIBLE ROHS
- 1-50u" NI UNDERPLATE
- 15u" Au CONTACT AREA
- 100u" TIN TAIL AREA ----- COMPATIBLE ROHS
- 2-50u" NI UNDERPLATE
- GOLD FLASH CONTACT AREA
- 100u" TIN TAIL AREA ----- COMPATIBLE ROHS
- 3-50u" NI UNDERPLATE
- 30u" Au CONTACT AREA
- 100u" TIN/LEAD TAIL AREA ----- INCOMPLIANT ROHS
- 4-50u" NI UNDERPLATE
- 15u" Au CONTACT AREA
- 100u" TIN/LEAD TAIL AREA ----- INCOMPLIANT ROHS
- 5-50u" NI UNDERPLATE
- GOLD FLASH CONTACT AREA
- 100u" TIN/LEAD TAIL AREA ----- INCOMPLIANT ROHS

PACKAGING OPTIONS

- T: TRAY PACKAGING(IN GENERAL VERTICAL DIRECTION)
C: TAPE & REEL WITH INSERT CAP (FOR 98P ONLY)
H: TRAY PACKAGING(IN SPECIAL HORIZONTAL DIRECTION FOR 164P ONLY)
P: TRAY PACKAGING WITH INSERT CAP
S: TRAY PACKAGING WITH INSERT CAP(IN SPECIAL HORIZONTAL DIRECTION)
- POS OPTIONS
- 0-36
 - 1-64
 - 2-98
 - 3-164

TAIL LENGTH OPTIONS

DIM "D"	PCB THICKNESS
3.85 +0.25 -0.13	1.56

LEAD FREE OPTIEION

"LF" FOR TERMINAL PLATING OPTION 0,1,2

CONNECTOR	#	POS REF.	N	DIM "A"	DIM "B"	DIM "C"	"E"	"F"
1 PORT	36	6	7.65	25.00	12.30	6.00	34.8	
4 PORT	64	20	21.65	39.00	26.30	20.00	48.8	
8 PORT	98	37	38.65	56.00	43.30	37.00	65.8	
16 PORT	164	70	71.65	89.00	76.30	70.00	98.8	

mat'l. code		surface		tolerance		projection		product family	
lfr	ecn no	dr	date	tolerances unless otherwise specified	ASME Y14.5	MM	MM	PCI_EXPRESS	PCI_EXPRESS
				angles	±0.30				
				±2°	.000±0.10				
		dr	ZHENHUA_LIU	2016-03-25				PCI_EXPRESS_CARD_EDGE_GEN3	
		engr	ZHENHUA_LIU	2016-03-25				STRADDLE_MOUNT_ASSY	
		chr	STONE_LI	2016-03-25					
		dppd	PM_ZHENG	2016-03-25					
sheet	revision	L							
index	sheet	7							



NOTES:

1. MATERIAL:
INSERT CAP: THERMOPLASTIC UL94V-0; BLACK COLOR.

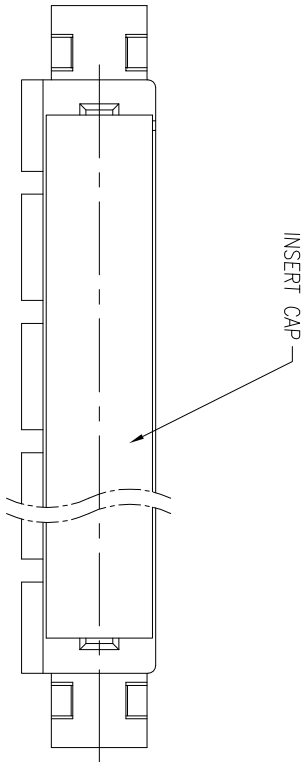

DIMENSIONS			
POSITION	F	G	
36	20.4	7.1	
64	34.4	21.1	
98	51.4	38.1	
164	84.4	71.1	

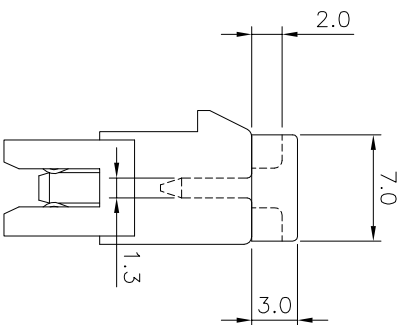
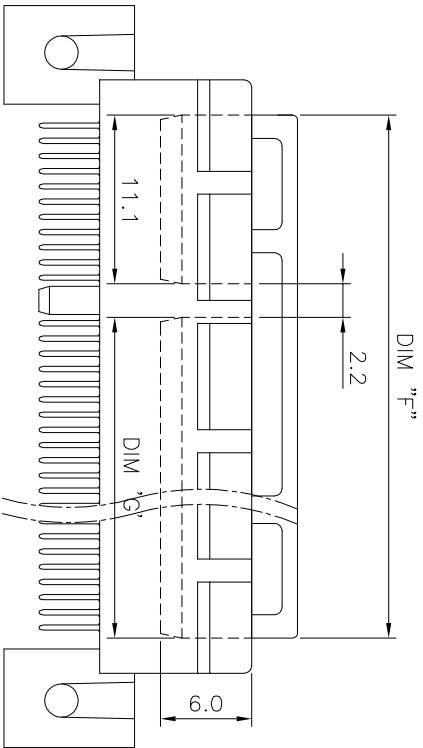

mat'l. code				surface		tolerance	projection		product family	
lfr	ecn	no	dr	date		ASME Y14.5			PCI_EXPRESS	
					tolerances unless otherwise specified					
					angles	±0.30				
					±2°	.000±0.10				
					dr	ZHENHUA_LIU	2016-03-25			
					engr	ZHENHUA_LIU	2016-03-25			
					chr	STONE_LI	2016-03-25			
					dppd	PM_ZHENG	2016-03-25			
sheet		revision	L							
index		sheet	7							

NOTE:

1. REEL MATERIAL : PS, BLACK
2. CARRIER MATERIAL : PS
3. COVER TAPE MATERIAL : PS
4. COVER TAPE REEL STRENGTHH : 13"
5. QUANTITY : 150 PCS/REEL
6. Carton : 380(L) * 380(W) * 300(H) mm

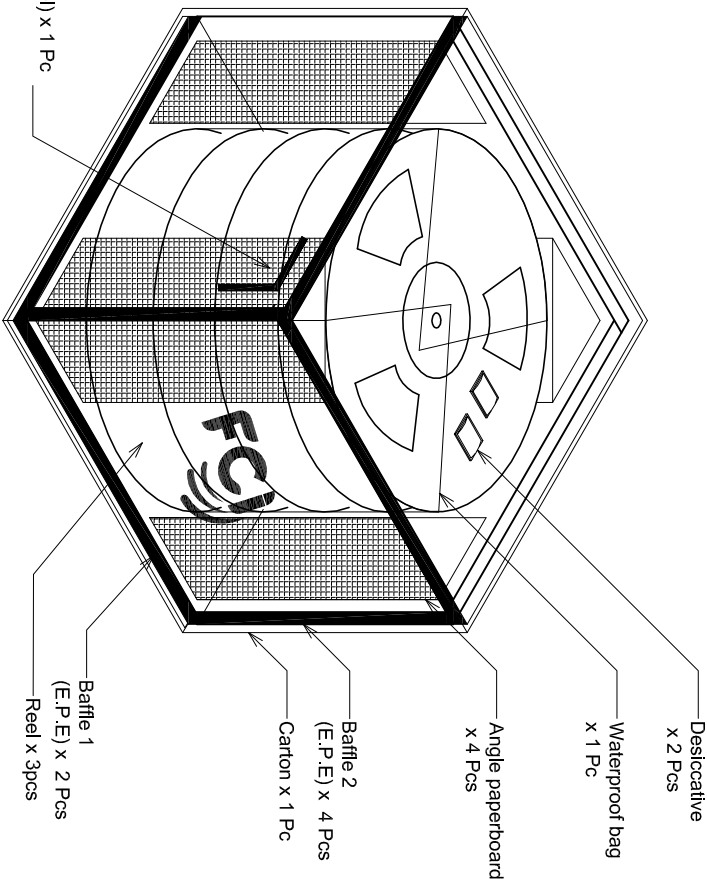
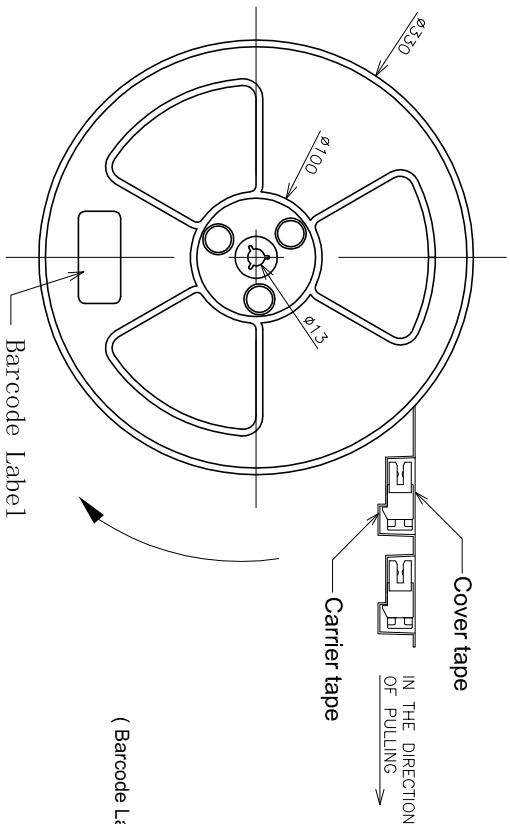
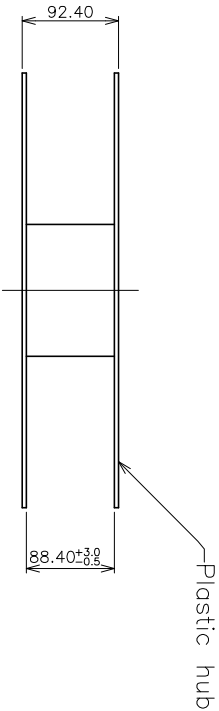

Part No
10025026-XXXXC(LF)

NO. OF CONTACTS	98
REEL/CARTON	3
PCS/REEL	150
QUANTITY(PCS)	450

mat'l. code	surface	tolerance	projection	product family
ecn no	dr	date	ASME Y14.5	PCI EXPRESS
angles	±2°	.000±0.10	MM	PCI_EXPRESS_CARD_EDGE_GEN3
dr	ZHENHUA_LIU	2016-03-25	scale N/A	STRADDLE_MOUNT_ASSY
engr	ZHENHUA_LIU	2016-03-25		
chr	STONE_LI	2016-03-25		
qppd	PM_ZHENG	2016-03-25		
sheet index	revision sheet	L 7		

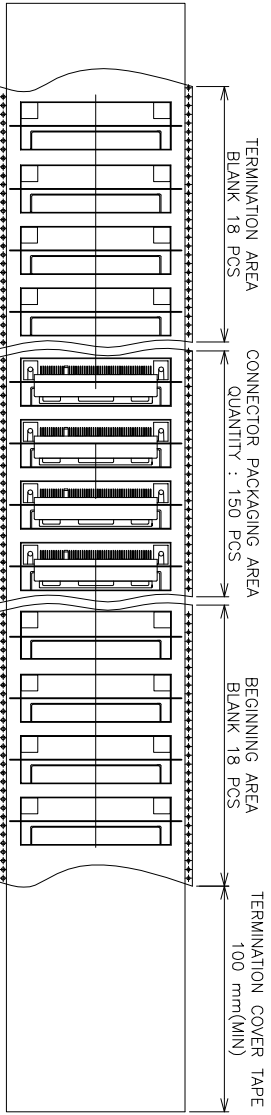
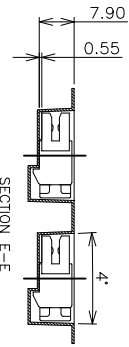
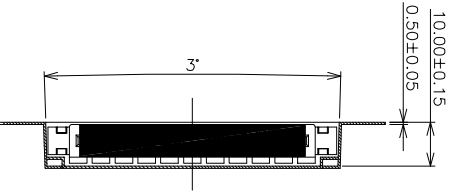
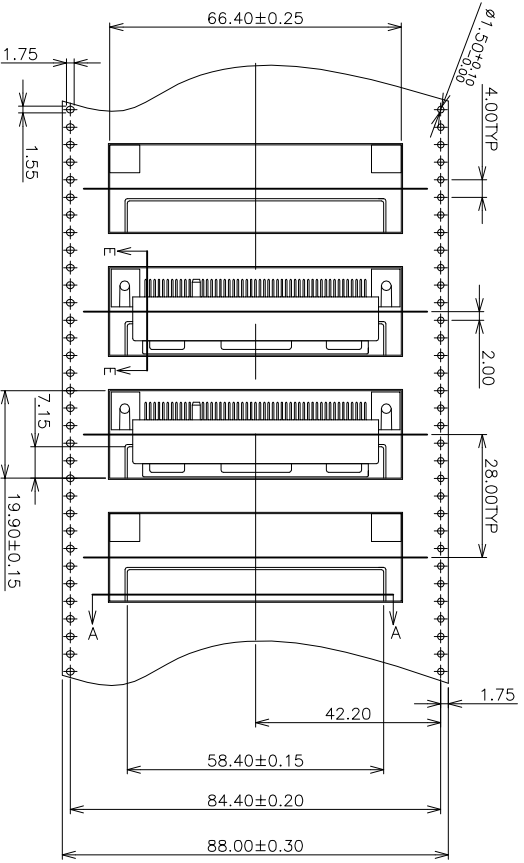

COMPOSITION OF PACKAGING

mat'l. code				surface		tolerance		projection		product family	
-				-		ASME Y14.5		-		PCI EXPRESS	
lfr	ecn no	dr	date	tolerances unless otherwise specified						title	
				angles						PCI EXPRESS_CARD_EDGE_GEN3	
				$\pm 2^\circ$						STRADDLE_MOUNT_ASS'y	
										dwg no	
				dr	ZHENHUA_LIU	2016-03-25				sheet 7 of 7	
				engr	ZHENHUA_LIU	2016-03-25				size	
				chr	STONE_LI	2016-03-25				A4	
				dppd	PM_ZHENG	2016-03-25				type	
sheet	revision	L								CUSTOMER Drawing	
index	sheet	7									