

ORDERING INFORMATION

Type	HFD41 HFD41A		/12VDC	-N	S	G	F	3	(XXX)
Coil voltage	3, 5, 6, 9, 12, 24 VDC								
Coil power	H: 200mW	N: 360mW	B: 450mW						
Construction ¹⁾²⁾	S: Plastic sealed		Nil: Flux proofed						
Contact plating	G: Gold plated ³⁾		Nil: No gold plated						
Insulation standard	F: Class F		Nil: Class B						
Contact capacity ³⁾	3: 3A (AgCdO, riveted contact) 5: 5A (AgCdO, riveted contact) Nil: 1A, 2A (AgNi, threaded contact)								
Special code ⁴⁾	XXX: Customer special requirement				Nil: Standard				

Notes: 1) Under the ambience with dangerous gas like H₂S, SO₂ or NO₂, plastic sealed type is recommended; Please test the relay in real applications. If the ambience allows, flux proofed type is preferentially recommended.

2) Contact is recommended for suitable condition and specifications if water cleaning or surface process is involved in assembling relays on PCB.

3) For gold plated type, the min. switching current and min. switching voltage is 10mA 5VDC. For 3A, 5A load products, only gold-plated contact is available.

4) The customer special requirement express as special code after evaluating by Hongfa.

OUTLINE DIMENSIONS, WIRING DIAGRAM AND PC BOARD LAYOUT

Unit: mm

Outline Dimensions

HFD41

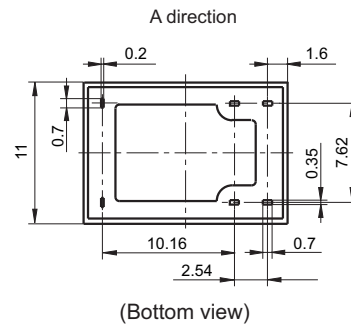
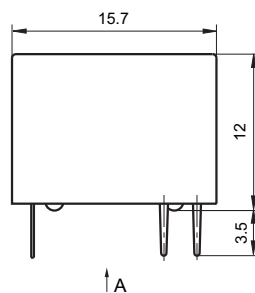

Wiring Diagram
(Bottom view)

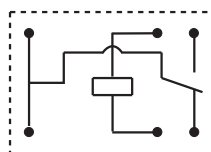

PCB Layout
(Bottom view)

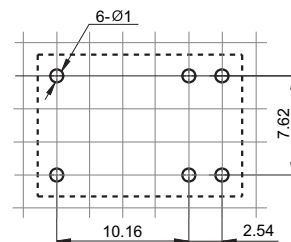

Unit: mm

HFD41A

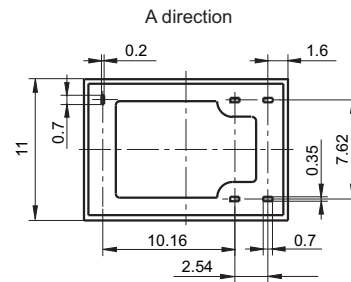

Technical drawing of a rectangular plate. The overall dimensions are 10.16 (width) and 7.62 (height). There are five holes, each with a diameter of 5-Ø1. The holes are arranged in two rows: three in the top row and two in the bottom row. The distance from the left edge to the center of the first hole in the top row is 10.16. The distance between the centers of the two holes in the bottom row is 2.54.

CHARACTERISTIC CURVES

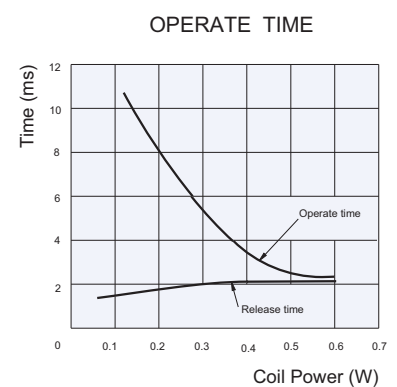

43