

PLATING CONTACT AREA:	
DASH NR:	PERFORMANCE LEVEL
-1YY	TELCORDIA CO
-2YY	CUSTOMER SPECIAL
-3YY	CUSTOMER SPECIAL
-9YY	TELCORDIA CO
-2YYLF	CUSTOMER SPECIAL
-9YYLF	TELCORDIA CO
-1YYLF	TELCORDIA CO
-3YYLF	CUSTOMER SPECIAL

PC BOARD VERSIONS		
PRODUCTNR:	PCB THICKNESS	DIM "A"
70231-X02LF	1.6	2.90
70231-X12LF	2.4	3.53

14.64 REF. SEE NOTE 6

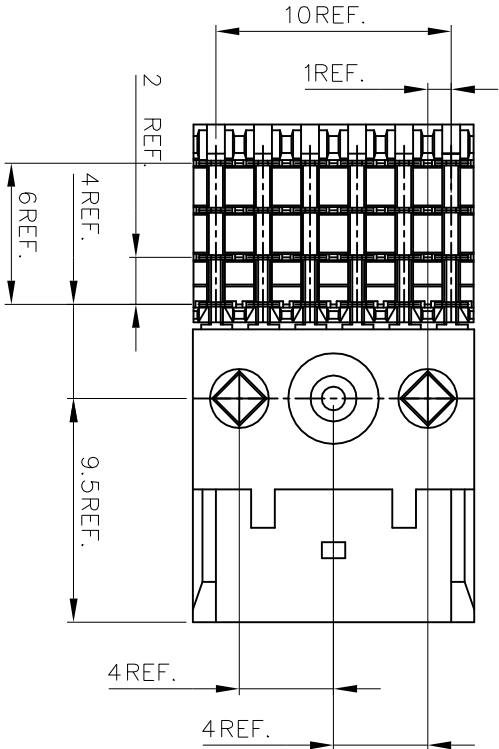
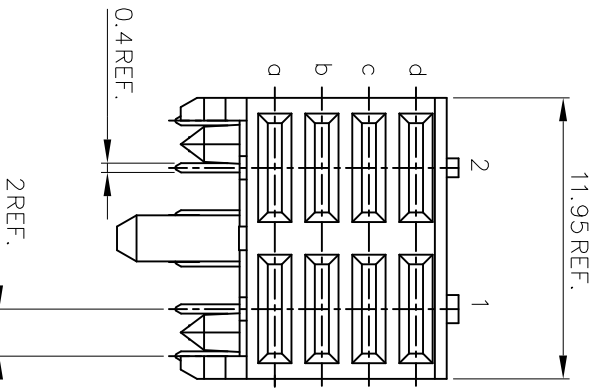
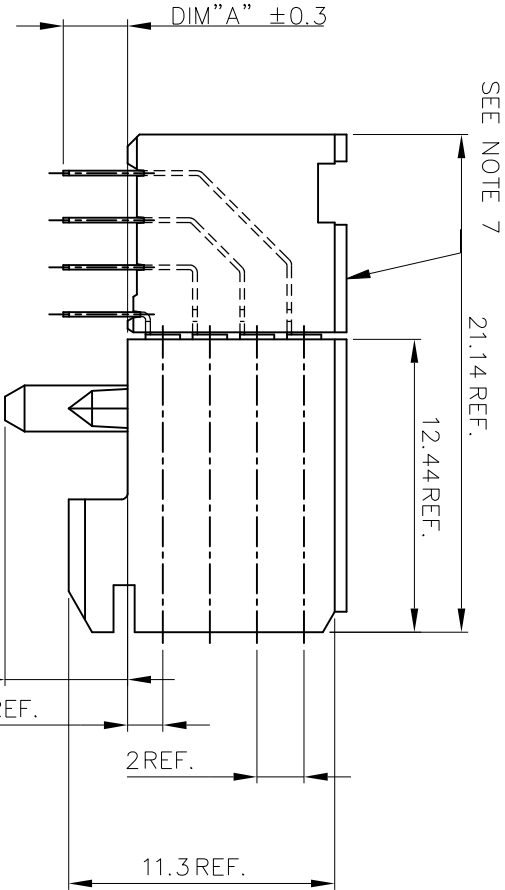

PC BOARD THICKNESS ±0.20  
SEE TABLE

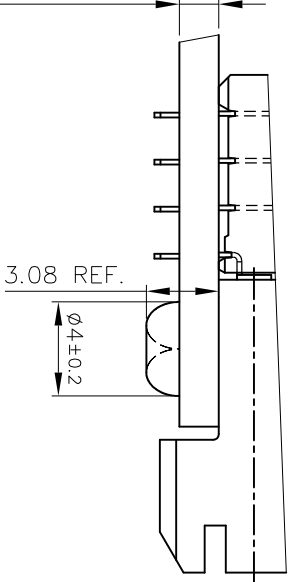

PRODUCT AFTER HOT RIVETING.

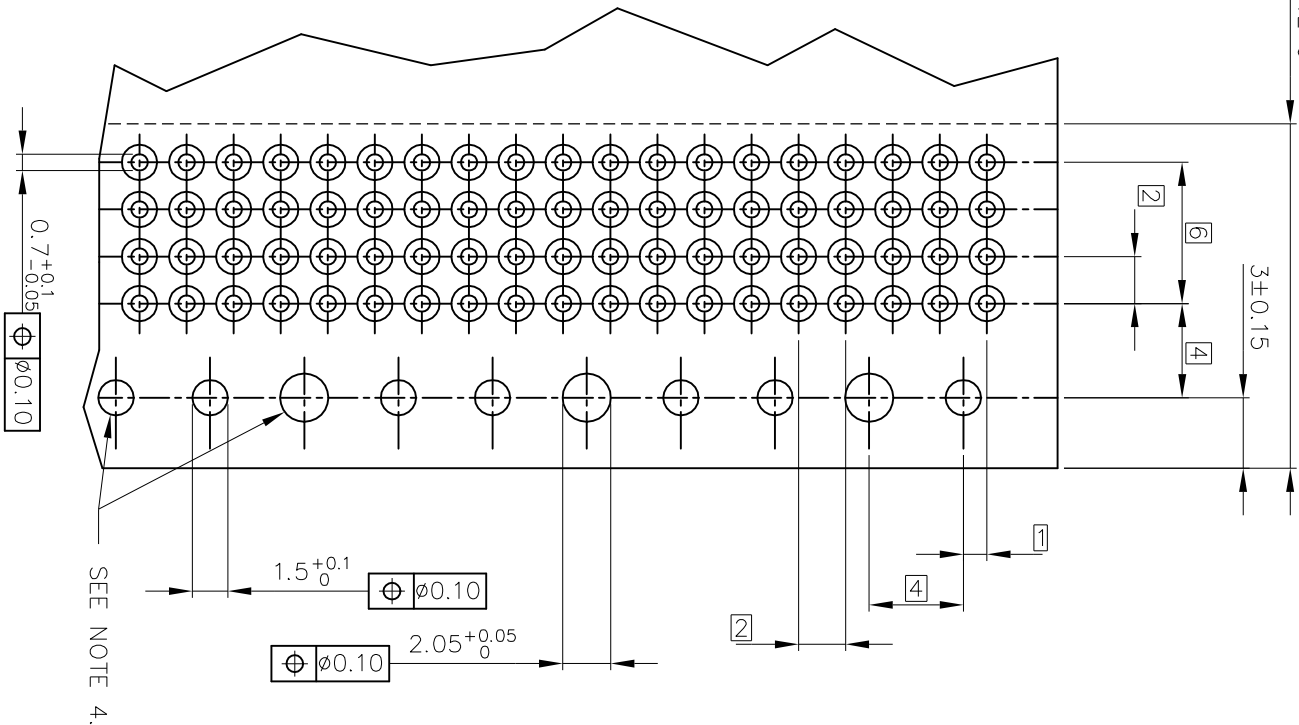

RECOMMENDED HOLE PATTERN,  
COMPONENT SIDE.

NOTES:

- 1 BODY MAT'L: LIQUID CRYSTAL POLYMER 30% GLASS FLAME RETARDANT ACC. UL 94-V0
- 2 TERMINAL MATERIAL: PHOSPHOR BRONZE.
- 3 INDICATED HOLES ARE UNPLATED.
- 4 PRODUCT MARKING: PART NUMBER & BATCH ID.
- 5 SET BACK FOR PRESS BLOCK.
- 6 TOP SURFACE OF PRESS BLOCK MAY EXTEND UP TO 0.4MM HIGHER THAN HOUSING. THIS MAY AFFECT THE TAIL LENGTH BEFORE APPLICATION TO A BOARD
- 7 THIS PRODUCT MEETS EUROPEAN UNION DIRECTIVES AND OTHER COUNTRY REGULATIONS AS DESCRIBED IN GS-22-008
- 8 THE HOUSING WILL WITHSTAND EXPOSURE TO 260DEGREE PEAK TEMPERATURE FOR 10 SECONDS IN A WAVE SOLDER APPLICATION.
- 9 THE PRODUCT SPECIFICATION GS-12-453.
- 10 FOR THE PRODUCT WITH 30u" GOLD PLATING IN TERMINAL, THEY CAN BE REPLACED BY 30 GXT PLATING.

