

| PRODUCT NO. | FINISH | UNREELING DIRECTION |
|----------------|---------|---------------------|
| 10044403-101LF | NOTE 2d | FIG.1 |
| 10044403-101LF | NOTE 2b | FIG.1 |

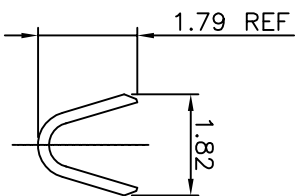

SECTION A-A

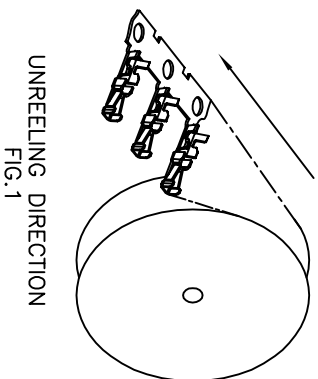
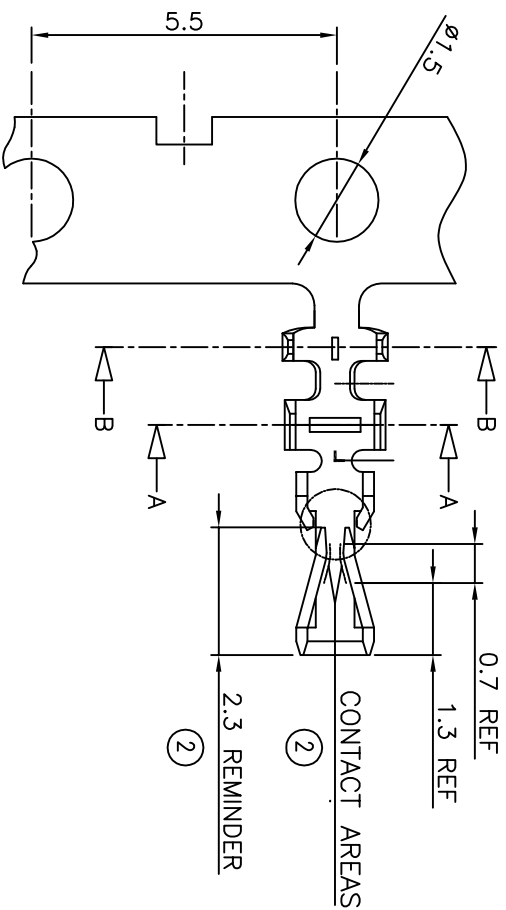
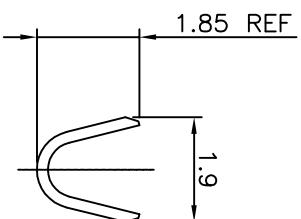

SECTION B-B

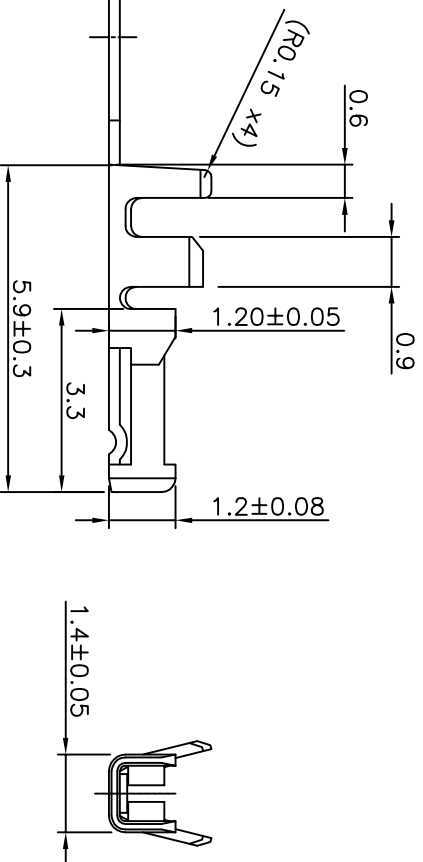
[illegible]

NOTES

- 1 MATERIAL : PHOSPHOR BRONZE
2 FINISH : .

② FINISH : .

d - SELECTIVE GOLD PLATING 0.76 μ m MIN

REMINDER : GOLD FLASH

b- 2.5µm-5µm MATTE TIN

REMINDER : 2.5 μ m-5 μ m MATTE TIN

UNDERPLATING: 1.27 μ m Ni MIN FOR BOTH

4 GENERAL TOLERANCE : ± 0.25

5 RECOMMENDED WIRE : LEONI FLRY-A 0.35 (AWG-22)

Ø1.35 MAX

6 THIS PRODUCT MEETS EUROPEAN UNION DIRECTIVES
AND OTHER COUNTRY REGULATIONS AS DESCRIBED IN
GS-22-008

7 CRIMP SPECIFICATION AS PER GS-20-058

8 PRODUCT SPECIFICATION : GS-12-415