

■ Dimensions in mm (not to scale)

## EVQPQ

(Embossed Taping)

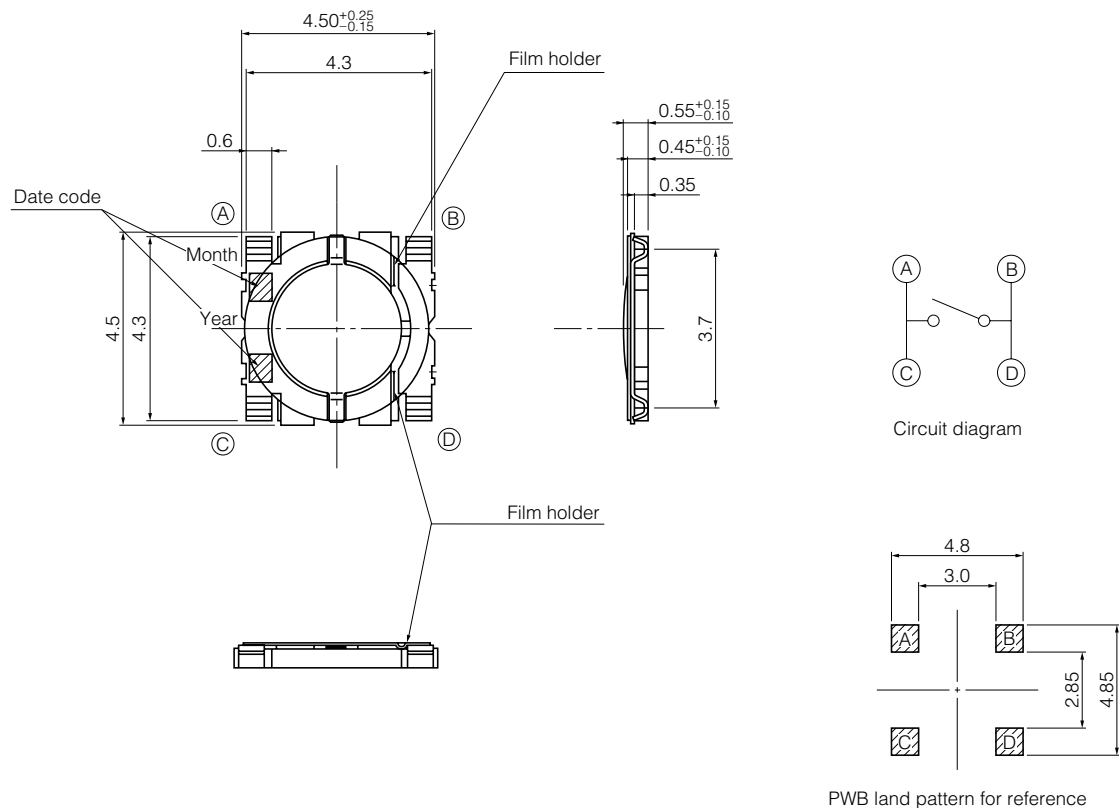

Part Numbers	Operating Force	Height	Operating Life
EVQPQHB55	1.6 N	0.55 mm	200000 cycles
EVQPQMB55	2.4 N	0.55 mm	50000 cycles

■ Before using this product

- If the inclination of the actuator is widened by using soft materials, such as rubber, for the setting side of the operation section (connecting area between button and actuator), it may cause functional problems.

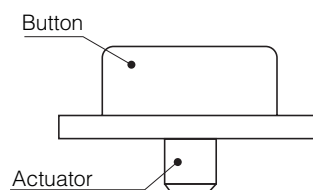

Design and specifications are each subject to change without notice. Ask factory for the current technical specifications before purchase and/or use. Should a safety concern arise regarding this product, please be sure to contact us immediately.

00 Oct. 2012

### ■ Recommended Reflow Soldering Conditions

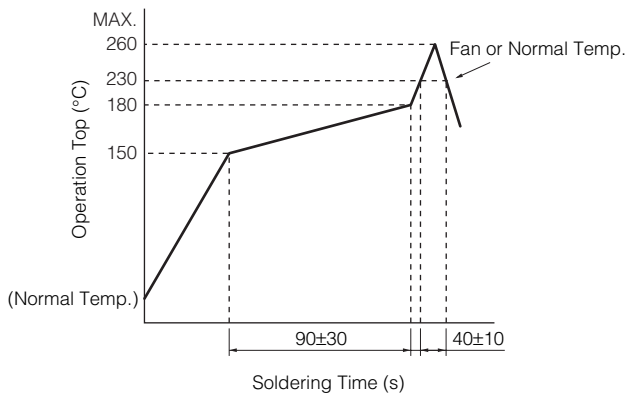

### ● Embossed Carrier Taping

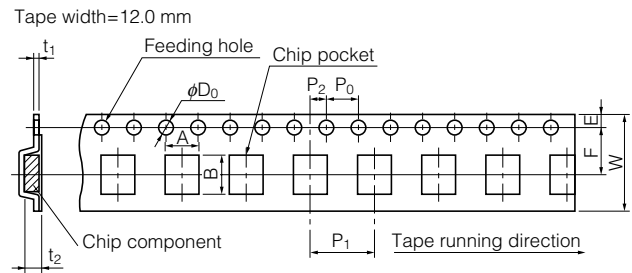

Unit: mm

Part No.	Height	A	B	W	F	E	P <sub>1</sub>	P <sub>2</sub>	P <sub>0</sub>	D <sub>0</sub> Dia.	t <sub>1</sub>	t <sub>2</sub>
EVQPQ	0.55	5.0 <sup>+0.30</sup> <sub>-0.25</sub>	4.6 <sup>+0.3</sup> <sub>-0</sub>	12.0±0.1	5.5±0.1	1.75±0.10	8.0±0.1	2.0±0.1	4.0±0.1	1.5 <sup>+0.1</sup> <sub>-0</sub>	0.30±0.05	0.65 <sup>+0.2</sup> <sub>-0.1</sub>

### ● Standard Reel Dimensions in mm (not to scale)

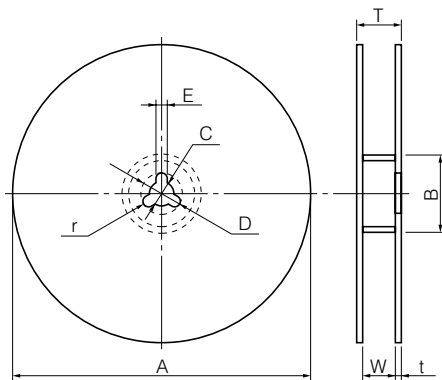

Item	A	B	C	D	E
Rate (mm)	φ370.0±2.0	φ50.0 min.	φ13.0±0.5	φ21.0±1.0	2.0±0.5

  

Item	W	T	t	r
Rate (mm)	14.0±1.5	—	1.0 to 3.0	1.0±0.5

### ■ Recommended Shape of Test Pole

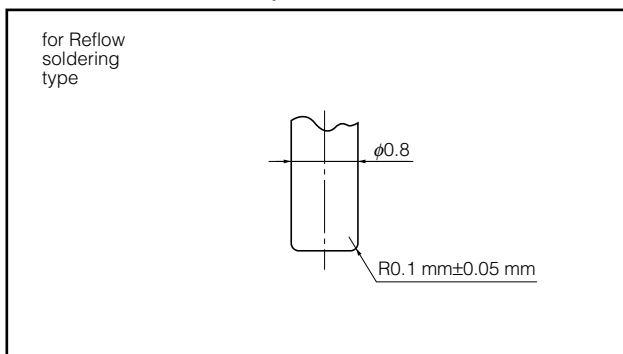

### ■ Recommended Operating Conditions

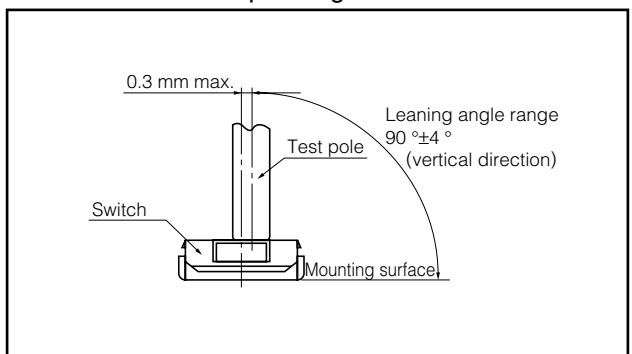

Design and specifications are each subject to change without notice. Ask factory for the current technical specifications before purchase and/or use.  
Should a safety concern arise regarding this product, please be sure to contact us immediately.

00 Oct. 2012