

PRODUCT NUMBER
SEE PART NO. TABLE

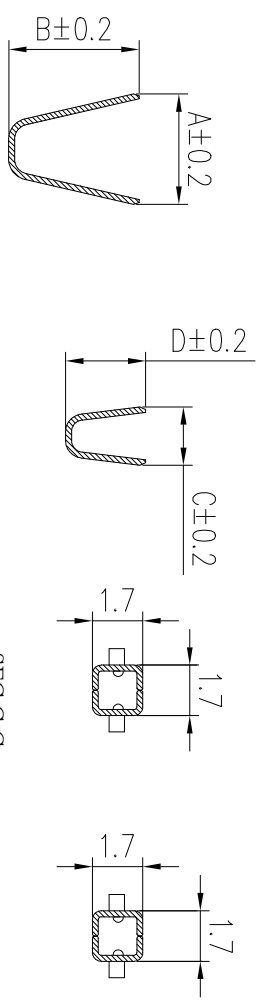
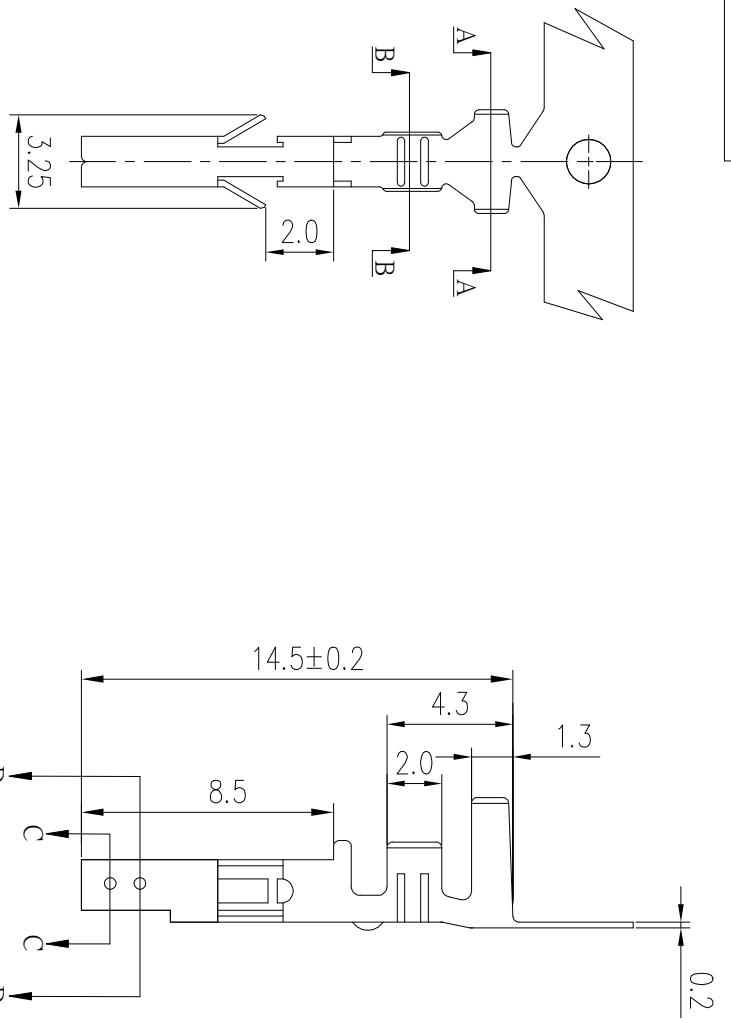

- NOTES:
1. MATERIAL: OPTIONAL.
 2. THIS TERMINAL IS USED WITH FCI RECEPTACLE HSG 10127815.
 3. PRODUCT SPECIFICATION: GS-12-1181.
 4. PACKAGE SPECIFICATION: GS-14-2362.
 5. PART NUMBER SCHEME:
10127817- X X X X X LF

- PLATING TYPE:
P: PRE-PLATED
BLANK: POST-PLATED
- APPLICABLE AWG:
1: AWG #16~#22
2: AWG #24~#28
- PLATING CODE:
1: GOLD FLASH
2: TIN
4: 30u" GOLD PLATING
- MATERIAL CODE:
1: PHOSPHORUS BRONZE
2: BRASS

6. DIMENSIONAL & PART NO. TABLE:

PART NO.	A	B	C	D	APPLICABLE WIRES
10127817-XX2XLF	3.2	3.4	1.8	2.2	#24~#28
10127817-XX1XLF	3.7	4.5	1.8	2.7	#16~#22

mat'l. code	surfc	tolerance	projection	product family
	ISO 1302	ISO 406 ISO	110°	WTB
	tolerances unless otherwise specified			
A	TAI 2013-11-11	0±.40	mm	title
B	EIX-T-17193 TAI 2014-03-12	infeed .00±.30	mm	RECEPTACLE TERMINAL FOR
C	EIX-T-18006 TAI 2014-06-19	0±.x'	mm	MINITEK PWR4.2 WIRE CONNECTOR
D	EIX-N-29392 TONY 2018-02-22	dr	scale 1:1	dwg no
	engr KENNY TAI	KENNY TAI		10127817
	chr KENNY TAI	KENNY TAI		sheet 1 of 1
	qppd PM ZHENG	2013-11-11		A3
sheet	revision	D		type
index	sheet	1		Product Customer Drawing