

# SMD Inductors(Coils) For Power Line(Wound, Magnetic Shielded)

Conformity to RoHS Directive

## VLC Series VLC4018

### FEATURES

- Miniature size  
Mount area: 4×4mm  
Height: 1.8mm max.
- Generic use for portable DC to DC converter line
- Available for automatic mounting in tape and reel package.
- The products do not contain lead and support lead-free soldering.

### APPLICATIONS

DC to DC converters for DVC, DSC, HDD, LCD displays, etc.

### SHAPES AND DIMENSIONS

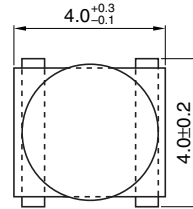

Dimensions in mm

### RECOMMENDED PC BOARD PATTERN

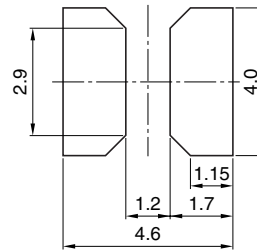

Dimensions in mm



### ELECTRICAL CHARACTERISTICS

Part No.	Inductance (μH)	Inductance tolerance	Test frequency (kHz)	DC resistance(Ω)		Rated current(A)*	
				max.	typ.	Based on inductance change max.	Based on temperature rise typ.
VLC4018T-1R5N	1.5	±30%	100	0.046	0.037	2.0	3.1
VLC4018T-2R2N	2.2	±30%	100	0.065	0.052	1.5	2.8
VLC4018T-3R3N	3.3	±30%	100	0.071	0.059	1.3	2.6
VLC4018T-4R7M	4.7	±20%	100	0.099	0.083	1.2	2.2
VLC4018T-6R8M	6.8	±20%	100	0.13	0.11	0.98	1.8
VLC4018T-100M	10	±20%	100	0.19	0.16	0.85	1.6
VLC4018T-150M	15	±20%	100	0.30	0.25	0.64	1.2
VLC4018T-220M	22	±20%	100	0.42	0.35	0.53	1.0
VLC4018T-330M	33	±20%	100	0.64	0.53	0.46	0.84

\* Rated current: Value obtained when current flows and the temperature has risen to 40°C or when DC current flows and the nominal value of inductance has fallen by 30%, whichever is smaller.

- Operating temperature range: -40 to +105°C (Including self-temperature rise)

• Conformity to RoHS Directive: This means that, in conformity with EU Directive 2002/95/EC, lead, cadmium, mercury, hexavalent chromium, and specific bromine-based flame retardants, PBB and PBDE, have not been used, except for exempted applications.

• All specifications are subject to change without notice.