

(SMT) SURFACE MOUNT TEST POINTS ON TAPE & REEL

AVAILABLE ON TAPE AND REEL

- Manufactured using flat wire to provide a large mounting surface area
- Efficient, safe, board level testing
- Simplifies testing on dense circuit boards
- Compatible with vacuum and mechanical pick & place assembly systems
- All conductive polystyrene carrier tape meets ANSA/EIA-481 standards

- Ideal for use with miniature probes, clips and hooks
- Ultra low profile, ideal for advanced surface mount PCB applications

MICRO MINIATURE

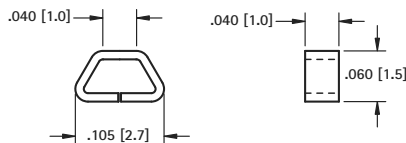

Pad Layout

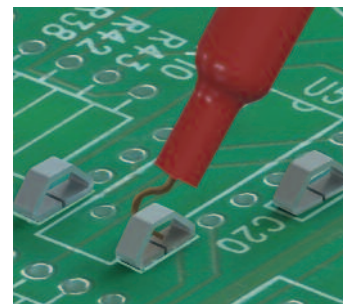
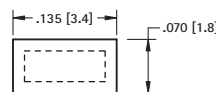

SPECIFICATIONS

Material:

.010 (.25) Phosphor Bronze, Silver Plate

CAT. NO. 5015 - 1000 pieces per reel

CAT. NO. 5017 - 5000 pieces per reel

Tape & Reel Spec's: 8mm Wide, 4mm Pitch

- Ideal for use with most standard probes, clips and hooks
- Unique design provides exceptional strength and durability

MINIATURE

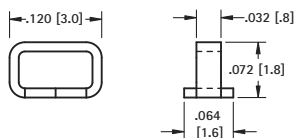

Pad Layout

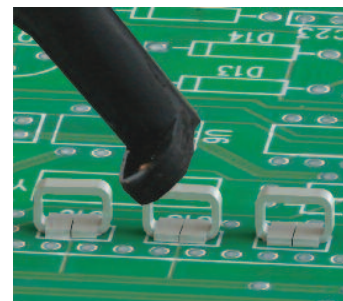
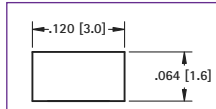

SPECIFICATIONS

Material:

.015 (.38) Phosphor Bronze, Silver Plate

CAT. NO. 5019 - 1000 pieces per reel

CAT. NO. 5029 - 5000 pieces per reel

Tape & Reel Spec's: 12mm Wide, 4mm Pitch

- Ideal for use with most standard probes, clips and hooks
- Color keyed for visibility and quick identification

COLOR KEYED

MATERIAL

Terminal: .008 (.20) Phosphor Bronze, Silver Plate

Base: LCP UL Rated 94V-0

CAT. NO.	Base Color	CAT. NO.	Base Color
5190TR	RED	5195TR	BROWN
5191TR	BLACK	5196TR	GREEN
5192TR	WHITE	5197TR	BLUE
5193TR	ORANGE	5198TR	GREY
5194TR	YELLOW	5199TR	PURPLE

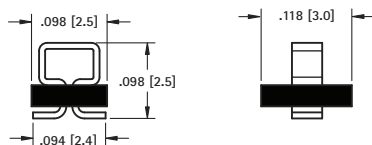

Pad Layout

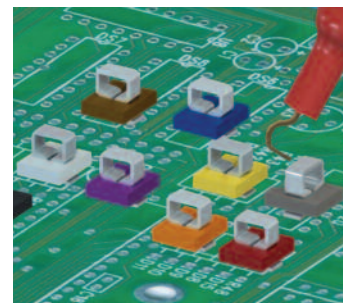
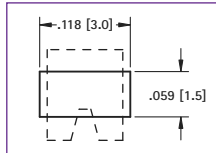

Tape & Reel Spec's: 12mm Wide, 4mm Pitch, 1,000 pieces per 7" reel

- Ideal for use with standard probes, clips and hooks
- Unique design provides exceptional strength and durability

COMPACT

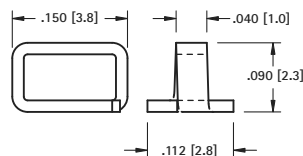

Pad Layout

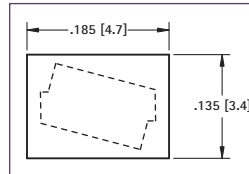

SPECIFICATIONS

Material:

.015 (.38) Phosphor Bronze, Silver Plate

CAT. NO. 5016 - 1000 pieces per reel

CAT. NO. 5018 - 5000 pieces per reel

Tape & Reel Spec's: 12mm Wide, 4mm Pitch

- Locating Pin provides positive location during assembly process
- Increased solder strength
- Can be used as a SMT test point or when used with a .032 [.81] board, as a THM test point

HYBRID MOUNT

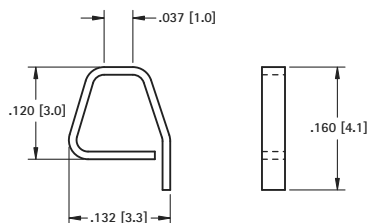

Pad Layout

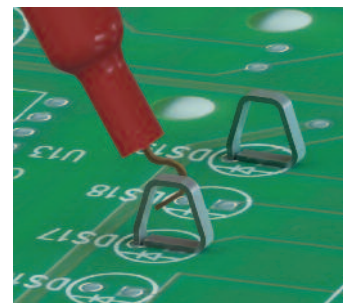
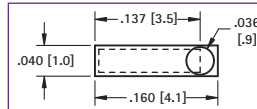

SPECIFICATIONS

Material:

.010 (.25) Phosphor Bronze, Silver Plate

CAT. NO. 5027 - 800 pieces per reel

Tape & Reel Spec's: 12mm Wide, 4mm Pitch