

About Amphenol Commercial Products

Amphenol's commercial connector products are used in a variety of end user applications including networking, telecom, server & computer, storage & HDD, consumer electronics and entertainment, professional audio & Industrial & Military/Aerospace.

Related Products

RJULE

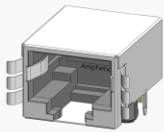

P/N RJULE-4X182-01 SHOWN SINGLE PORT REGULAR MOUNT, STANDARD SHIELD WITH SMT

FRJAE



P/N FRJAE-418 SHOWN SINGLE PORT, 8 POSITION, WITH FERRITE FILTER AND SHIELD (FRONT TABS)

RJLSE

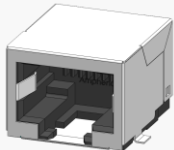

P/N RJLSE-41181-01 SHOWN SINGLE PORT REGULAR MOUNT, STANDARD SHIELD WITH SMT

ELECTRICAL CHARACTERISTICS

Contact Resistance	20 mΩ maximum
Insulation Resistance	500 MΩ minimum at 500V DC for 2 minutes maximum
Current Rating	1.5 Amps per contact
Voltage Rating	125 Volts AC
DWV	1500 VAC, 60 HZ. 1 min

Supports PoE, PoE+, and PoE++ per IEEE PoE standards

IP20 rated per IEC 60529

MECHANICAL CHARACTERISTICS

Mating Connector Insertion Force	5.0 lbs maximum
Mating Connector Pull Retention Force	20.0 lbs minimum
Durability	750 mating and unmating cycles for 50μ" gold plating
Recommended Soldering Temperature	Lead free reflow soldering up to 260°C for 10 seconds (refer to reflow profile below, maximum of 3 reflow passes permitted)
Operating Temperature	-40°C to +85°C

UL File # E135615

Connectors are suitable for IR Reflow.

Refer to J-STD-033 for safe handling procedures for SMDs.

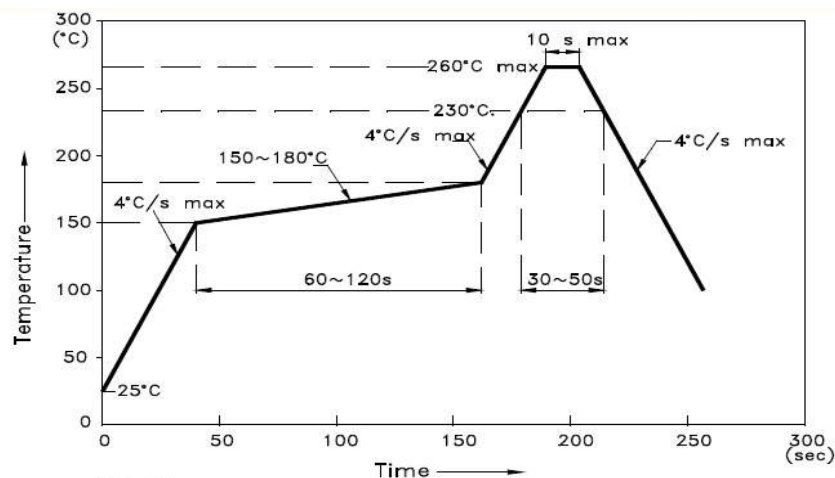

Amphenol Canada Corp.
605 Milner Avenue
Toronto, Ontario, Canada M1B 5X6

www.amphenolcanada.com (www.amphenol-icc.com)
(416) 291-4401
sales@amphenolcanada.com

Copyright © Amphenol Corporation 2018 · All rights reserved

Page 2 of 3

Amphenol

About Amphenol Commercial Products

Amphenol's commercial connector products are used in a variety of end user applications including networking, telecom, server & computer, storage & HDD, consumer electronics and entertainment, professional audio & Industrial & Military/Aerospace.

MATERIAL REQUIREMENTS

RJSSE connectors are RoHS compliant.

Unless otherwise specified, the materials for each component shall be:

Insulator	High temperature thermoplastic, flammability rating UL 94V-0
Contacts	-Phosphor Bronze hard temper with gold thickness options (6μ", 15μ" 30μ", 50μ") over 50μ" minimum Nickel on contact mating area -100μ" minimum matte Tin over Nickel on soldering tail
Shield	Copper alloy, Nickel or matte Tin plating
Light Pipe	Optical grade polycarbonate, UL 94V-0

MOISTURE LEVEL SENSITIVITY

The Moisture Level Sensitivity for the RJSSE connector is MSL-1.

AVAILABLE DOCUMENTS

Below is a list of the most popular standard sales drawings:

Contact our website, sales, or an authorized Amphenol representation for additional drawings.

RJSSE-7061	Single port, surface mount, unshielded, with light pipes
RJSSE-7060	Single port, surface mount, unshielded, no light pipes
RJSSE-5580	Single port, surface mount, shielded without side tabs, no light pipes
RJSSE-5F80-01T	Single port, surface mount, shield without tabs and boardlock
RJSSE-5383-02T	Two ports, surface mount, shield with EMI tabs, with light pipes

Related Products

RJSSE

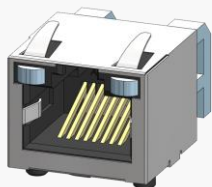

P/N RJSSE-5081 SHOWN
SINGLE PORT, 8 POSITION,
WITH SHIELD AND LIGHT PIPE

RJSAR

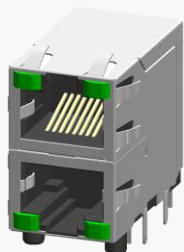

P/N RJSAR-5385-02 SHOWN
STACKED 2X1, 8 POSITION, WITH
SHIELD AND LEDs

Amphenol Canada Corp.
605 Milner Avenue
Toronto, Ontario, Canada M1B 5X6

www.amphenolcanada.com (www.amphenol-icc.com)
(416) 291-4401
sales@amphenolcanada.com

Copyright © Amphenol Corporation 2018 · All rights reserved

Page 3 of 3

Amphenol

THIS DOCUMENT CONTAINS PROPRIETARY INFORMATION AND SUCH INFORMATION MAY NOT BE DISCLOSED TO OTHERS FOR ANY PURPOSE OR USED FOR MANUFACTURING PURPOSES WITHOUT WRITTEN PERMISSION FROM AMPHENOL CANADA CORP.