

3M™ MicroTouch™ Display C1500SS Specifications

Functional Features

| | |
|--|--|
| LCD Technology | TFT, Active Matrix |
| Display Colors | 16.2 million |
| Pixel Pitch | .297 mm |
| Brightness without Touch Screen | 250 cd/m ² (nit) typical |
| Brightness with Touch Screen (max.) ¹ | 225 cd/m ² (nit) typical |
| Contrast Ratio | 500:1 typical |
| Video Response Time | 12 ms typical |
| Touch Response Time | 5.4 ms typical |
| Viewing Angle ² | Horizontal: +/-75 degrees typical Vertical: +/-75 degrees typical |
| Control Type | OSD |
| On Screen Display Controls | Standard rear mounted controls. Optional remote unit. |
| Maximum Resolution | 1024 x 768 |
| Operating Environment | 0 to +40 degrees C Relative Humidity, non-condensing 90% |
| Storage Environment | -20 to +60 degrees C |

Physical Features

| | |
|---|--|
| Physical Dimensions (Enclosure) (WxHxD) | 350.4 x 277.3 x 50 mm 13.80 x 10.92 x 1.96 inches |
| Display Area (WxH) | 304.1 x 228.1 mm 11.9 x 8.9 inches |
| Video Cable Connector | 15 Pin D-Sub |
| Power Supply Internal | 12V DC Power Supply Also accepts 110/220V AC |
| Power Savings | DPMS, VESA Compliant |
| Power Consumption | <25 watts normal operation |
| Backlight Life | 50,000 hrs. typical |
| Weight | 4.2kg/9.2 lbs. |
| RoHS Compliant | Yes |
| Agency Approvals | FCC B, CE, UL/cUL |
| Mounting Options | Set of 2, side or top/bottom mounting brackets, VESA 75 mm |
| Warranty | 3 years. unlimited touches |

(1) Brightness measured on a display with 3M™ MicroTouch™ Sensor SCT3250 surface capacitive sensor.

(2) Measured at a contrast ratio of 5.

NOTE: Mechanical Drawings available at www.3m.com/touch



Slimline Bezel
(Included with standard product)
350.4 x 277.3 mm
13.80 x 10.92 inches



Optional Remote On-screen Display Module
(Part number: 30114)



Contour Flanged Bezel Option
(Part number: 29369)
377.8 x 301.8 mm
14.87 x 11.88 inches



Optional Heavy Duty Mounting Bracket
(Part number: 30113)



Industrial Flanged Bezel Option
(Part number: 29368)
411.0 x 316.9 mm
16.18 x 12.48 inches

Standard Part Numbers

| Part Number | Description |
|-----------------|----------------------------|
| 11-71315-225-01 | USB with Slimline Bezel |
| 11-71315-227-01 | Serial with Slimline Bezel |
| 11-71315-225-03 | USB with Contour Bezel |

3M Touch Systems

Subsidiary of 3M Company
501 Griffin Brook Park Drive
Methuen, MA 01844
U.S.A.

1-888-659-1080

www.3m.com/touch

RoHS Directive compliant: In accordance with European Directive 2002/95/EC, "RoHS Directive compliant" means that the product or part does not contain any of the following substances in excess of the following maximum concentration values in any homogeneous material, unless the substance is in an application that is exempt under RoHS: (a) 0.1% (by weight) for lead, mercury, hexavalent chromium, polybrominated biphenyls or polybrominated diphenyl ethers; or (b) 0.01% (by weight) for cadmium. Unless otherwise stated by 3M in writing, this information represents 3M's knowledge and belief based on information provided by third party suppliers to 3M. (9/06)

IMPORTANT NOTICE TO PURCHASER: Specifications are subject to change without notice. These 3M Touch Systems' Products and software are warranted to meet their published specifications from the date of shipment and for the period stated in the specification. 3M Touch Systems makes no additional warranties, express or implied, including but not limited to any implied warranties of merchantability or fitness for a particular purpose. User is responsible for determining whether the 3M Touch Systems Products and software are fit for User's particular purpose and suitable for its method of production, including intellectual property liability for User's application. If the Product, software or software media is proven not to have met 3M Touch Systems' warranty, then 3M Touch Systems' sole obligation and User's and Purchaser's exclusive remedy, will be, at 3M Touch Systems' option, to repair or replace that Product quantity or software mediator to refund its purchase price. 3M Touch Systems has no obligation under 3M Touch Systems' warranty for any Product, software or software media that has been modified or damaged through misuse, accident, neglect, or subsequent manufacturing operations or assemblies by anyone other than 3M Touch Systems. 3M Touch Systems shall not be liable in any action against it in any way related to the Products or software for any loss or damages, whether non-specified direct, indirect, special, incidental or consequential (including downtime, loss of profits or goodwill) regardless of the legal theory asserted. (7/02)



MicroTouch™ CT150 Touch Monitor – Bezel Options

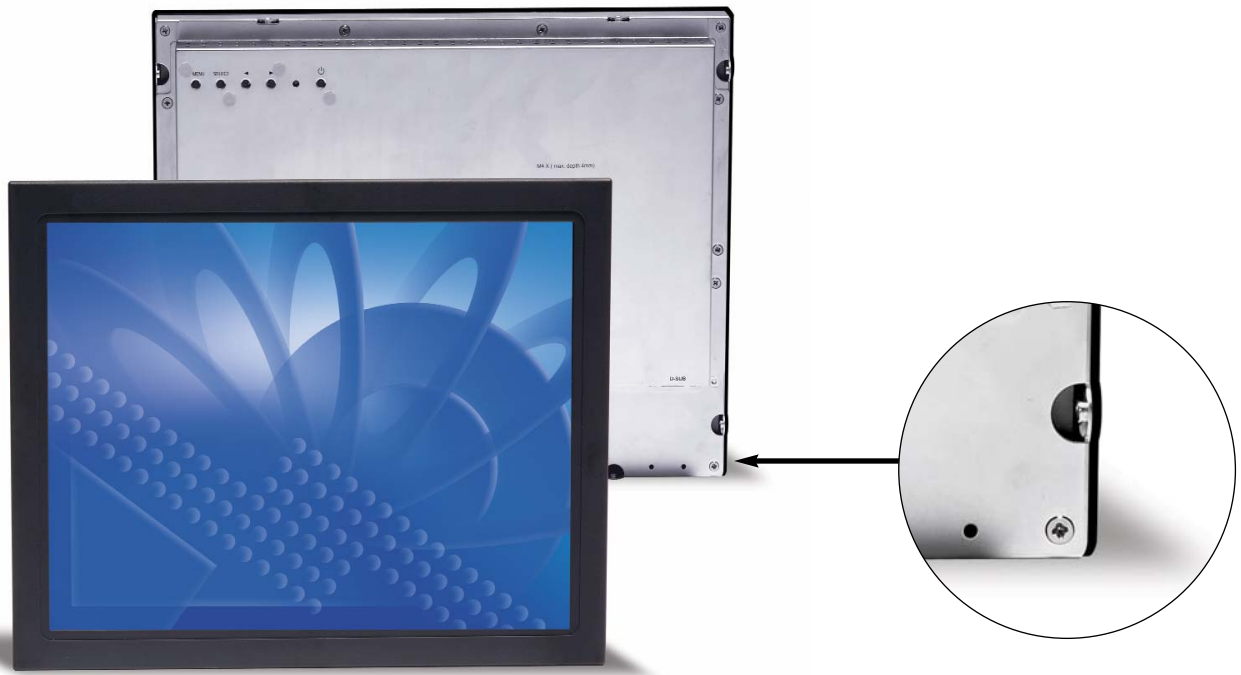

CT150 Touch Monitor with Slimline Bezel (standard)

Standard product includes bezel shown. Bezel is flush to edges of display.
Reinforced bosses on monitor case for bracket mounting. Ideal for rear mount applications.



CT150 Touch Monitor with Contour Flanged Bezel (optional)

This bezel is contoured on the front to resemble a desktop monitor bezel.
Designed for front mount or “drop-in” applications. Bezel only, monitor sold separately. (Part number: 29369)

MicroTouch™ CT150 Touch Monitor – Bezel Options



CT150 Touch Monitor with Industrial Flanged Bezel (optional)

Rugged, gasketed bezel with wide flange and multiple attachment points to both the display and the enclosure.
Bezel only, monitor sold separately. (Part number: 29368)



Top Mount Configuration



Side Mount Configuration



Standard Steel Mounting Brackets
(standard with CT150 Touch Monitor)

MicroTouch™ CT150 Touch Monitor Mounting Bracket

Heavy-duty VESA Mounting Bracket

(Part number: 30113, shown below with CT150 and Contour Flanged bezel)

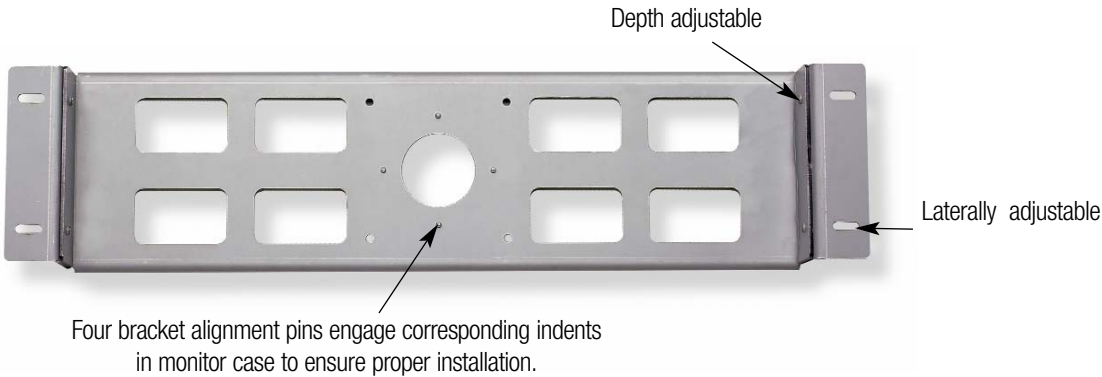

MicroTouch™ CT150 Touch Monitor Arm Mounting Option



Arm Mounting Option

75mm VESA-compliant mounting pattern attaches to an array of ergonomic arms, mounts and bases...an ideal configuration for any application where installation flexibility is required.

Mounting arm (courtesy of Ergotron) and cable management tubing shown here are not available from 3M.

MicroTouch™ CT150 Touch Monitor Mounting Options

**Slimline Bezel
Mounting Method**
(with standard brackets)

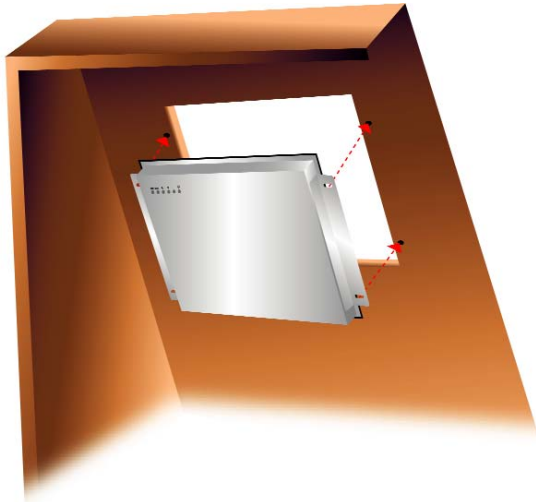

**Contour Flanged Bezel
Mounting Method**
(with standard brackets)

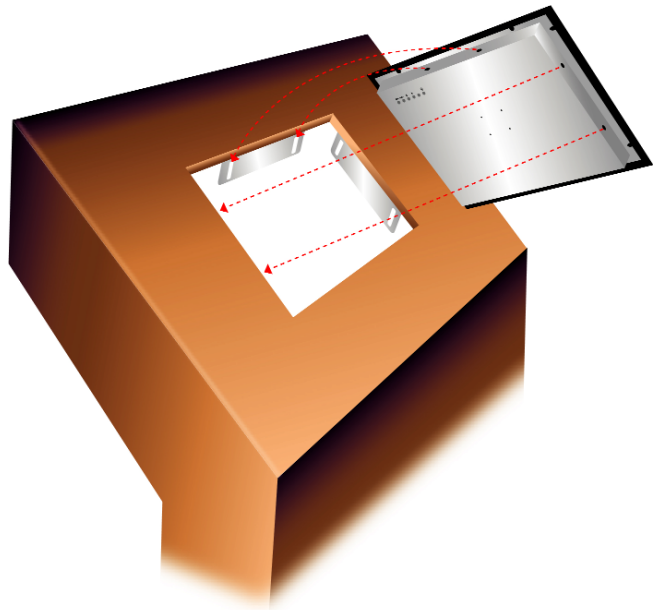

**Contour Flanged Bezel
Mounting Method**
(with optional VESA-mounting bracket)

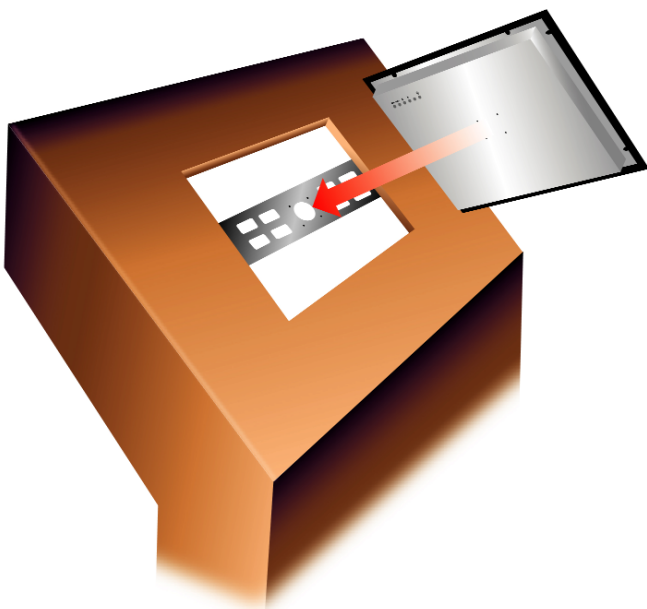

**Industrial Flanged Bezel
Mounting Method**
(no brackets required)

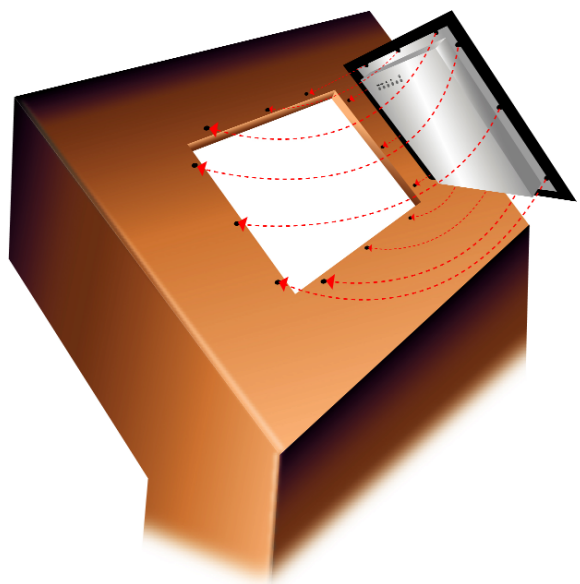

MicroTouch™ CT150 Touch Monitor Connectors/Controls

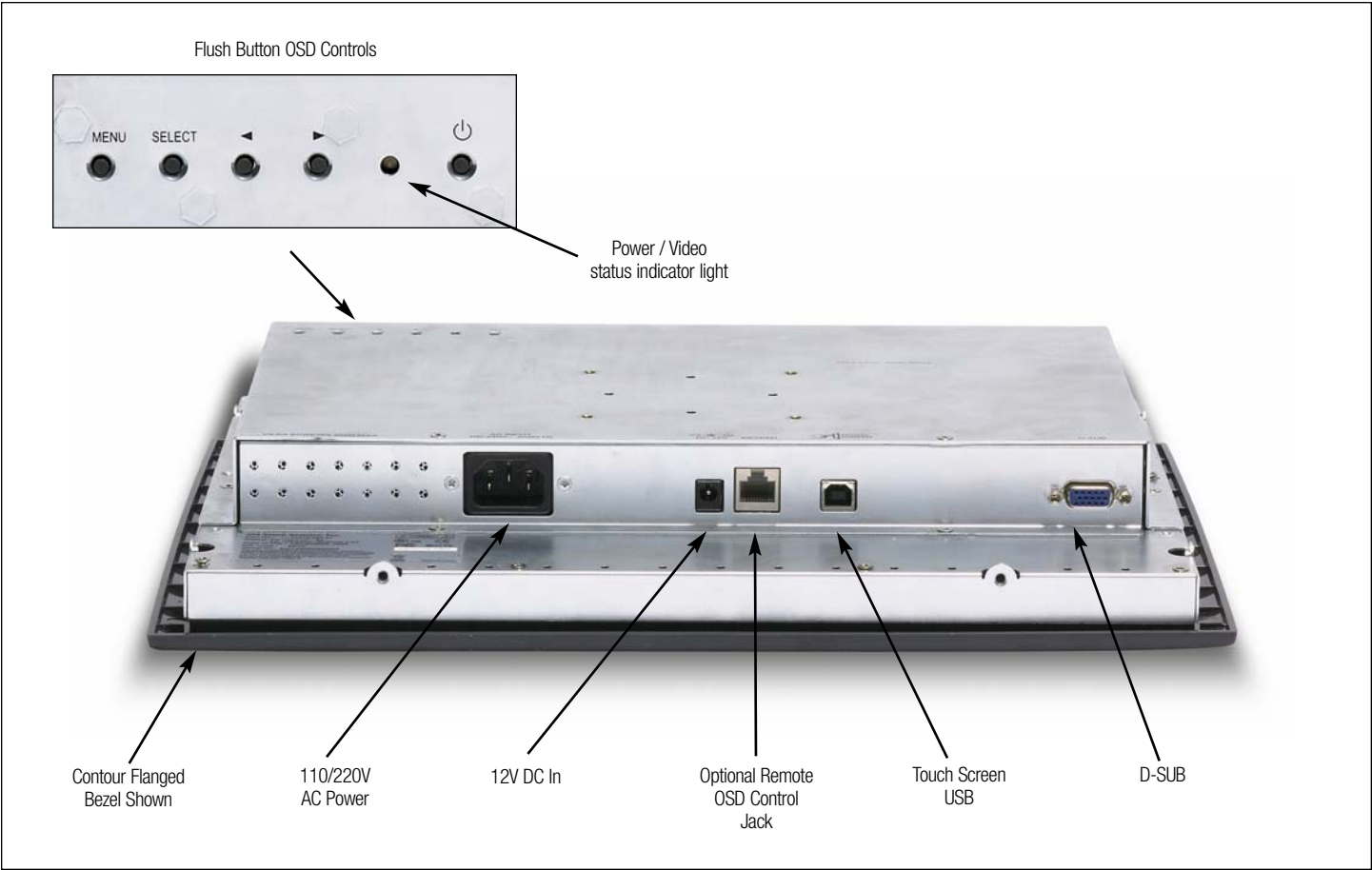

CT150 Touch Monitor Remote OSD Control

Simplifies video adjustment of installed monitors. (Part Number: 30114)



MicroTouch™ ClearTek™ II Capacitive Touch Screen Technology



MicroTouch™ ClearTek™ II Capacitive Touch Screen Technology
(mounted to LCD display)

