

## SOCKETS FOR TO-3 CASE

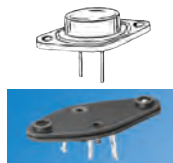

Socket and transistor are assembled to chassis at same time, using the minimum amount of hardware. Top molded boss ensure the transistor leads will be isolated from the chassis. Various boss heights available to accommodate different chassis thicknesses.

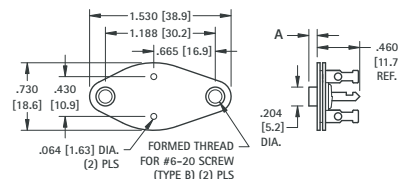

CAT. NO.	A DIM.
4603	.030 (.76)
4602	.045 (1.14)
4601	.090 (2.29)

### VARIOUS MOLDED BOSS HEIGHTS

#### MATERIAL:

**Base:** Phenolic, Grade PBE, Type XP

**Contacts:** Brass, Tin Plate

**Top Plate:** Nylon, ASTM-D4066

Phenolic, Grade PBE, Type XP

(Cat. No. 4606 only)

**Collector Plate:** Steel, Tin Plate

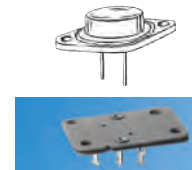

Socket is installed onto chassis using eyelets or screws. Transistor is installed afterwards. Assembly and repairs are simplified since socket will stay in place without transistor mounted. Top molded boss or added bushing ensure the transistor leads will be isolated from the chassis. Various boss heights available to accommodate standard chassis thicknesses. Use Cat. No. 4606 and nylon bushings for special chassis thicknesses.

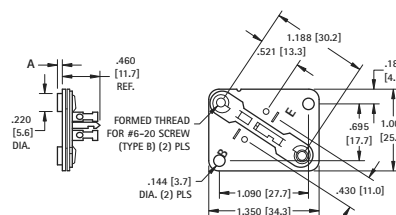

CAT. NO.	A DIM.
4606	NONE
4607	.030 (.76)
4608	.045 (1.14)
4609	.060 (1.52)
4618	.125 (3.2)

## FULLY MOLDED TO-3 SOCKET



CAT. NO. 4620

Pre-assembling the socket to the chassis by eyelets or rivets permits the installation of the semiconductor at a later stage in the assembly. The molded top boss eliminates hardware.

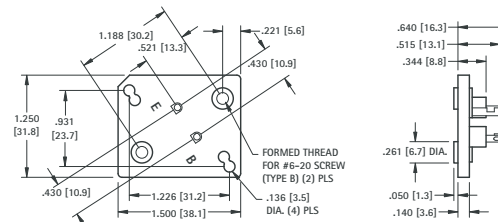

#### MATERIAL:

**Base:** Molded Nylon 6/6

**Contacts:** Brass, Tin Plate

**Collector Plate:** Steel, Tin Plate

## HEAVY DUTY SOCKET FOR TO-3 CASE

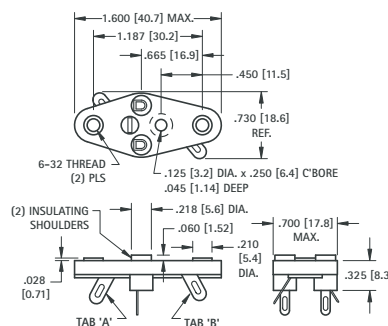

### CHOICE OF SINGLE OR DUAL COLLECTOR SOLDER TABS

Features an all-in-one mounting plate and solder tabs, providing complete electrical isolation of the solder tab connections.

Rated 5 Amps DC continuous and 15 Amps DC Intermittent



#### MATERIAL:

**Base:** Glass Filled Polyester, UL Rated 94V-0

**Contacts:** Brass, Tin Plate

**Collector Plate:** Brass, Tin Plate

### With transistor lead-in insulating shoulders

CAT. NO.	WITH TAB
4513	"A" ONLY
4514	"A" & "B"

### Less transistor lead-in insulating shoulders

CAT. NO.	WITH TAB
4515	"A" ONLY
4516	"A" & "B"

## TO-3 CASE MOUNTING KITS

These socket kits provide everything needed to mount a transistor onto a chassis in one kit. Nylon bushings or boss will insulate transistor leads from chassis. Mica insulator isolates transistor from chassis. Two 6-20 screws included to mount transistor. (Transistor not included)

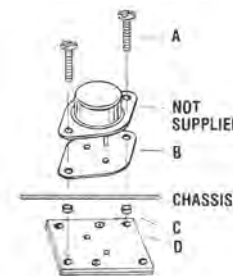
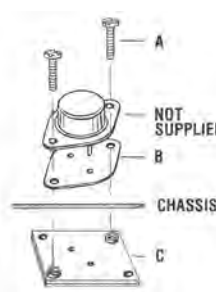
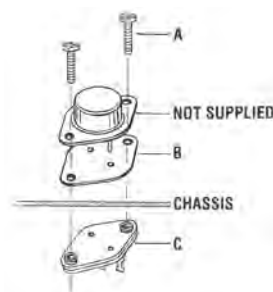

CAT. NO. 4732 Complete Mounting Kit			
ITEM	CAT. NO.	DESCRIPTION	QUANTITY
A	4706	6-20 screws	2
B	4651	Mica Insulator	1
C	4602	Socket	1

CAT. NO. 4733 Complete Mounting Kit			
ITEM	CAT. NO.	DESCRIPTION	QUANTITY
A	4706	6-20 screws	2
B	4651	Mica Insulator	1
C	4608	Square Socket	1

CAT. NO. 4734 Complete Mounting Kit			
ITEM	CAT. NO.	DESCRIPTION	QUANTITY
A	4706	6-20 screws	2
B	4651	Mica Insulator	1
C	4684	Nylon Bushing	4
D	4606	Square Socket	1

Tel (718) 956-8900 • Fax (718) 956-9040  
(800) 221-5510 • kec@keyelco.com

**KEYSTONE**  
RoHS COMPLIANT ~ ISO 9001 CERTIFIED

www.keyelco.com  
31-07 20th Road - Astoria, NY 11105-2017

## TRANSISTOR INSULATORS

• Rapid Heat Dissipation • High Dielectric Strength • Low Cost

These precision stamped mica insulators provide good thermal conductivity: Excellent thermal resistance 1100°F (593°C) Dielectric constant of 7 at 1000 KHz.  
.009 watts per square inch per degree celsius per inch in thickness.

**MATERIAL:** .003 (.08) ± .001 (.02) Thick Mica

### FOR TO-3 CASES

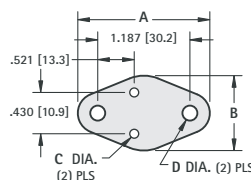

CAT. NO.	A	B	C	D
4651	1.625 (41.3)	1.093 (27.8)	.093 (2.36)	.166 (4.2)
4652	1.560 (39.6)	1.050 (26.7)	.203 (5.15)	.171 (4.4)
4653	1.655 (42.1)	1.063 (27.0)	.166 (4.2)	.166 (4.2)
4636	1.655 (42.1)	1.063 (27.0)	.052 (1.32)	.166 (4.2)
4644	1.655 (42.1)	1.063 (27.0)	.270 (6.9)	.166 (4.2)

### FOR THREADED STUD TRANSISTORS

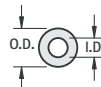

CAT. NO.	ID	OD	For Screw Size
4678	.120 (3.1)	.375 (9.5)	4
4679	.144 (3.7)	.375 (9.5)	6
4680	.171 (4.3)	.500 (12.7)	8
4681	.196 (5.0)	.625 (15.9)	10
4682	.260 (6.6)	.750 (19.0)	1/4
4683	.328 (8.3)	.875 (22.2)	5/16

### FOR TO-66 CASES

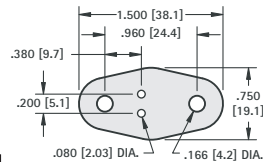

CAT. NO. 4664

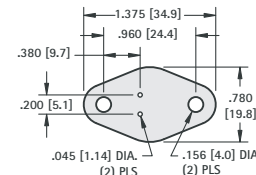

CAT. NO. 4666

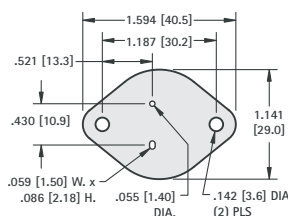

CAT. NO. 4662

### FOR TO-3 CASES

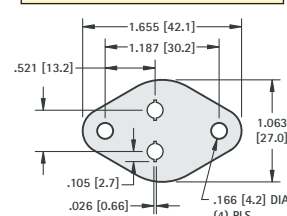

CAT. NO. 4667

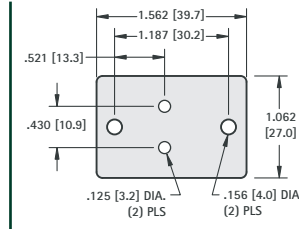

CAT. NO. 4661

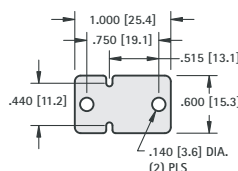

CAT. NO. 4663

### FOR PLASTIC CASE

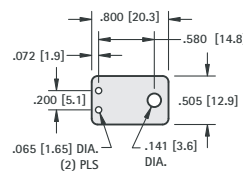

CAT. NO. 4671

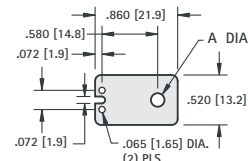

CAT. NO.	A
4672	.141 (3.6)
4673	.115 (2.9)

## TRANSISTOR MOUNTING KITS

• Complete Kits or Individual Hardware • Pre-Packaged • Uniform Hardware at Low Cost

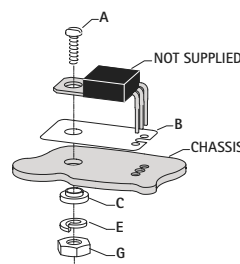

### FOR TO-220 CASE

ITEM	CAT. NO.	DESCRIPTION	QTY.
A	4690	4-40 Screw	1
B	4672	Mica Insulator	1
C	3049	Shoulder Washer	1
E	4693	Lockwasher	1
G	4694	4-40 Nut	1

These pre-packaged universal mounting kits provide all the necessary hardware and insulators required to securely mount the semiconductor to the chassis. Purchase the complete kit consisting of all hardware included in one package. Your choice of individual items available in 100 piece packages. Semiconductors customer supplied.

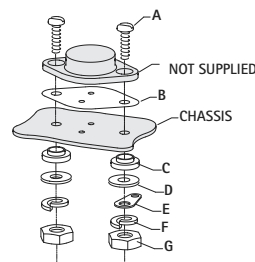

### FOR TO-3 CASE

ITEM	CAT. NO.	DESCRIPTION	QTY.
A	4696	6-32 Screw	2
B	4651	Mica Insulator	1
C	4698	Shoulder Washer	2
D	4699	Metal Washer	2
E	4004	Solder Terminal	1
F	4700	Lockwasher	2
G	4701	6-32 Nut	2

### FOR TO-66 CASE

ITEM	CAT. NO.	DESCRIPTION	QTY.
A	4696	6-32 Screw	2
B	4666	Mica Insulator	1
C	4698	Shoulder Washer	2
D	4699	Metal Washer	2
E	4004	Solder Terminal	1
F	4700	Lockwasher	2
G	4701	6-32 Nut	2

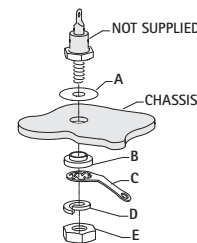

### FOR DO-4, TO-59, TO-60, TO-62 CASES

ITEM	CAT. NO.	DESCRIPTION	QTY.
A	4681	Mica Insulator	1
B	4702	Shoulder Washer	1
C	4704	Solder Terminal	1
D	1477	Lockwasher	1
E	4705	10-32 Nut	1

### FOR DO-5, TO-48, TO-61 CASES

ITEM	CAT. NO.	DESCRIPTION	QTY.
A	4682	Mica Insulator	1
B	4711	Shoulder Washer	1
C	4712	Solder Terminal	1
D	1476	Lockwasher	1
E	4713	1/4-28 Nut	1