

Vanadium Pentoxide Lithium Coin Batteries (VL Series): Individual Specifications

VL2330

■ Dimensions(mm)

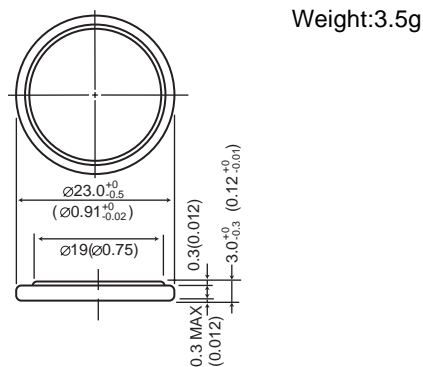

Note: This bare cell diagram is for size reference only. Please refer to the tab configurations at the end of this section for available tabs.

VL3032

■ Dimensions(mm)

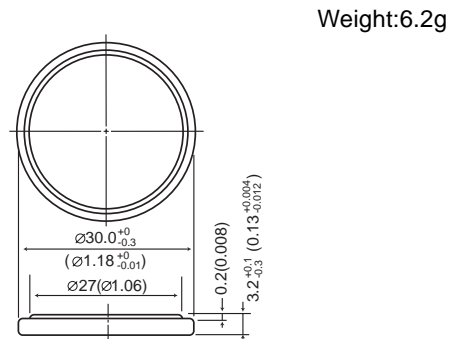

Note: This bare cell diagram is for size reference only. Please refer to the tab configurations at the end of this section for available tabs.

■ Specification

| | |
|-------------------------------|-----------|
| Nominal voltage (V) | 3 |
| Nominal capacity (mAh) | 50.0 |
| Continuous standard load (mA) | 0.1 |
| Operating temperature (C) | -20 ~ +60 |

■ Specification

| | |
|-------------------------------|-----------|
| Nominal voltage (V) | 3 |
| Nominal capacity (mAh) | 100.0 |
| Continuous standard load (mA) | 0.2 |
| Operating temperature (C) | -20 ~ +60 |

■ Discharge Temperature Characteristics

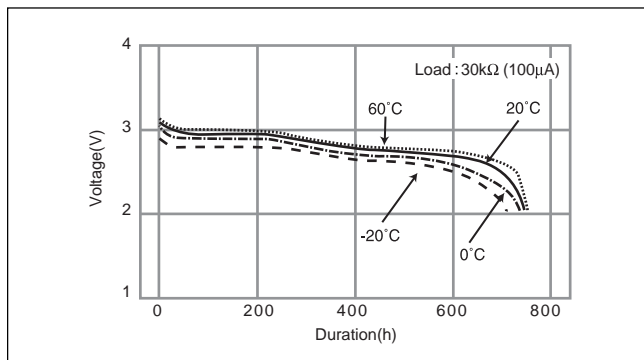

■ Discharge Temperature Characteristics

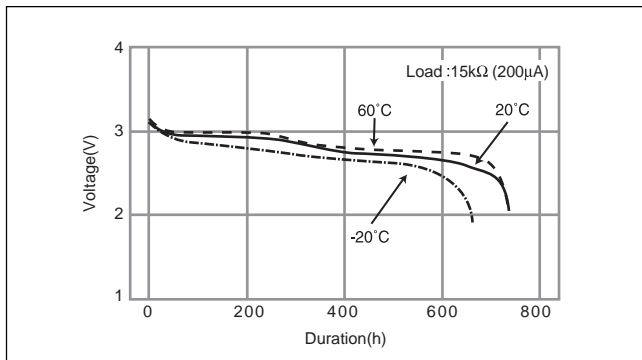

■ Consumption current vs. Duration time

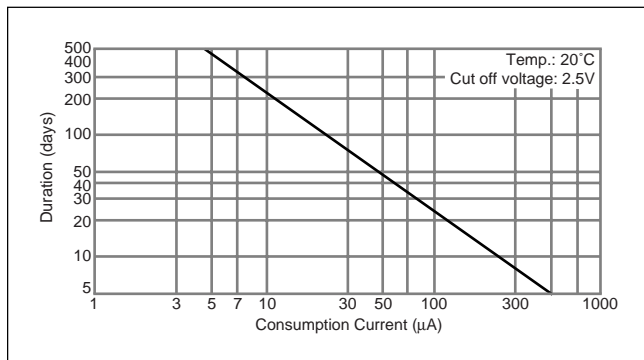

■ Consumption current vs. Duration time

